

Society for the Scientific
Study of Religion

#SSSR13

and

RELIGIOUS RESEARCH ASSOCIATION

#RRA13

Annual Meeting

2013

November 8-10

Westin Waterfront Boston

Boston, MA

CONCOURSE LEVEL

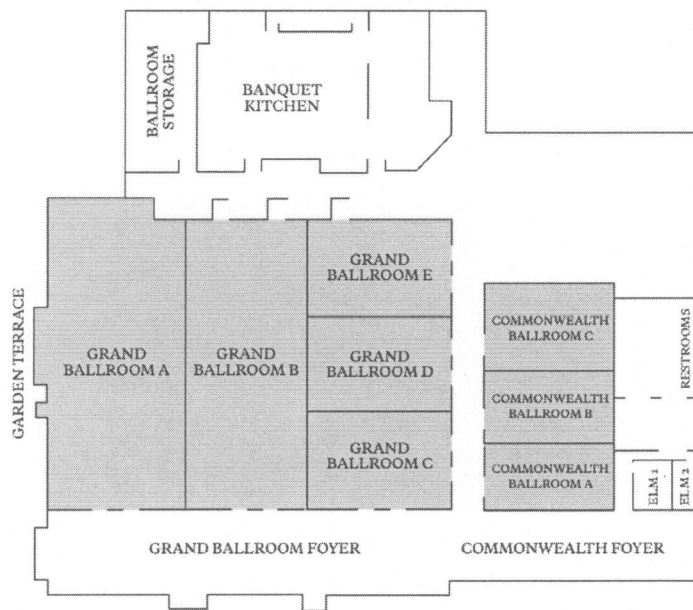

MEZZANINE LEVEL



LOBBY LEVEL



THE WESTIN

BOSTON
WATERFRONT

CONFERENCE LEVEL

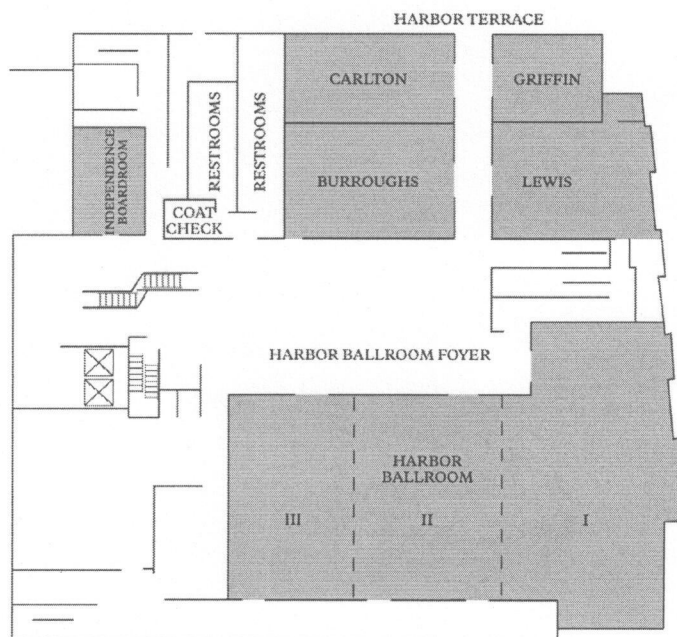

GALLERIA LEVEL

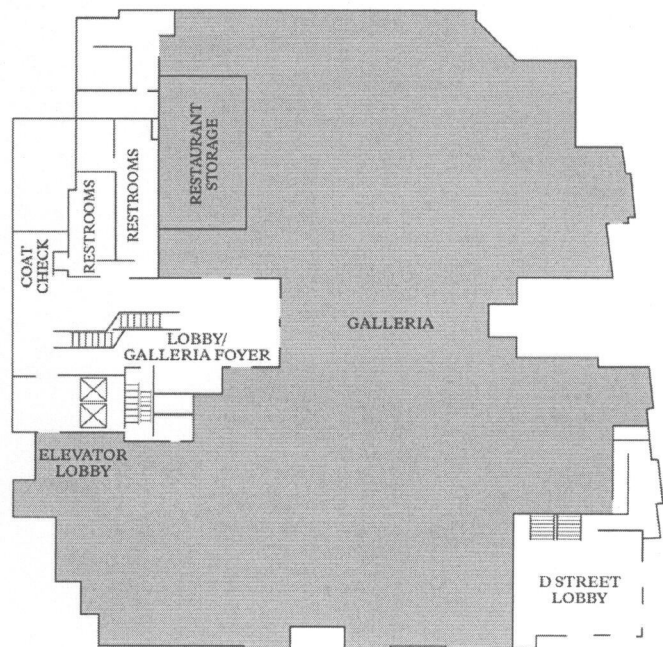

2013 Program Schedule

THURSDAY

8:00 am-12:00 pm
SSSR Council Meeting
Carlton

2:00 pm-4:00 pm
RRA Board Meeting
Carlton

6:00-9:00 pm
Registration
Harbor Ballroom Foyer

8:00-10:00 pm
Reception with Cash Bar
Harbor Ballroom Foyer

FRIDAY

8:00 AM-3:00 PM
Registration
Harbor Ballroom Foyer

8:00 AM-5:30 PM
Book Exhibit
Harbor 1

11:30 AM-12:45 PM
New Member and Awards
Lunch
(admission by ticket only)
Harbor 2-3

4:30-5:30 PM SSSR New Book Reception
Harbor 1
hosted by Oxford University Press

5:30-6:30 PM H. Paul Douglass Lecture
Harbor 2-3
R. Stephen Warner, University of Illinois
at Chicago, "In Defense of Religion"

6:30-7:30 PM RRA Reception
Harbor Ballroom Foyer

7:45 PM-8:30 PM Honoring the Life and Work of Otto Maduro
Burroughs
Organizer/Convener: Madeleine Cousineau, Mount Ida College

8:30 PM-10:00 PM Catholic Research Network Lecture and
Meeting (all welcome)
Lewis
"Pastoral Restructuring and the Parish Collaboratives," Rev.
Paul Soper, Director of the Office of Pastoral Planning, Arch-
diocese of Boston

Friday, November 8, 8:00-9:30 AM

A-1. RRA: From Peking to Pretoria: Inter-Group Relations and the Transformation of Religious Communities Across the Globe

Room: Bulfinch

Convener: Deborah Coe, Presbyterian Research Services (deborah.coe@pcusa.org)

Lost Tribes and Neo-Jews: Emergent Jewish Communities from the Developing World

Nathan Devir, University of Utah (nathan.devir@utah.edu)

Questions Concerning the Relevance of Seventh-day Adventist Teachings to Animist Cultures

Ronald Lawson, Queens College, CUNY (ronaldlawson@nyc.rr.com)

Cohesion and Community: Anglican Indaba Among Women in Cross-Cultural Context

Paula D. Nesbitt, Graduate Theological Union (paula_nesbitt@post.harvard.edu)

The Cultural Revolution, The Cult of Mao, and the Rise of the House Church Movement

Warren S. Goldstein, Harvard University (goldstein@criticaltheoryofreligion.org)

A-2. RRA: Author Meets Critics: *Paging God: Religion in the Halls of Medicine*, by Wendy Cadge (University of Chicago Press, 2012)

Room: Faneuil

Organizer/Convener: R. Stephen Warner, University of Illinois at Chicago (rswarner@uic.edu)

Discussant: Wendy Cadge, Brandeis University (wcadge@brandeis.edu)

Critic: George Fitchett, Rush University Medical Center (George_Fitchett@rush.edu)

Critic: Joy Charlton, Swarthmore College (jchart1@swarthmore.edu)

Critic: Michael J. Balboni, Harvard Medical School (Michael_Balboni@dfci.harvard.edu)

A-3. RRA: Creating Community in Local Congregations **Room: Hale**

Organizer/Convener: Cynthia Woolever, U.S. Congregational Life Survey/Presbyterian Church (USA) (cynthia@cynthiawoolever.com)

Small Groups and Civic Engagement: Examining Congregational Context

Andrew Whitehead, Presbyterian Church (U.S.A.) (andrew.whitehead@pcusa.org)

Samuel Stroope, Louisiana State University

Comparing Church Participants: Members and Non-Members

Jack Marcum, Presbyterian Church (U.S.A.) (jack.marcum@pcusa.org)

Joelle Kopacz, Presbyterian Church (U.S.A.)

The Pastor's Role in Creating a Sense of Belonging Among Members

Cynthia Woolever, Presbyterian Church (U.S.A.) (cynthia@cynthiawoolever.com)

Spectator Religion: Congregational Size and Member Participation

David Eagle, Duke University (david.eagle@duke.edu)

A-4. SSSR: Religious Effects on Stress and Well-being **Room: Douglass**

Convener: Josh Packard, University of Northern Colorado (Josh.Packard@unco.edu)

Religious Beliefs, Well-being and Life Stressors: Are They Connected?

Amy Hale, University of Connecticut (amy.hale-smith@uconn.edu)

A Personal Relationship with God: Effects on Self-Concept, Coping with Stress and Life Satisfaction

Jennifer Matoske, Boise State University (jmatoske@gmail.com)

Forgiveness, Religious Commitment, and Well-being in Adulthood: Persistent Associations Over Time and Life Stage

H. Wesley Perkins, Hobart & William Smith Colleges (perkins@hws.edu)

Friday, November 8, 8:00-9:30 AM

A-4, cont.

The Mental Health of Clergy: Assessing the Impact of Congregational and Denominational Factors

Jeremy Rhodes, Hardin Simmons University (jeremy.r.rhodes@hsutx.edu)

A-5. SSSR: Religion in Higher Education

Room: Adams

Convener: John W. Hawthorne, Spring Arbor University (john.hawthorne@arbor.edu)

The Extent of Saudi University Students' Perception of the Concepts of Human Rights and Their Compatibility with Islamic Culture
Khaled Alshunyber, King Saud University, Saudi Arabia (Khaled4288@gmail.com)

Influences of Gender-Related Religious Beliefs on Mentoring/Coaching Female College Students
Katy Tangenberg, Azusa Pacific University (ktangenberg@apu.edu)

Religious Context: Religious Ecologies Surrounding Denominationally-Affiliated Colleges and Universities
Jeffrey Tamburello, Baylor University (jeffrey_tamburello@baylor.edu)

Academic Freedom and Religious Control: An Interpretative Phenomenological Analysis into How Seminary Faculty Make Sense of Academic Freedom

Aaron Burgess, Cincinnati Christian University (aaron.burgess@ccuniversity.edu)

A-6. SSSR: Demographic Profiles and Change

Room: Alcott

Convener: Gary Bouma, Monash University (gary.bouma@monash.edu)

Demographic Dynamics in Iran: Religion and Social Change
Yaghoob Foroutan, Mazandaran University/Waikato University (y_foroutan@yahoo.com)

The Global Religious Landscape

Conrad Hackett, Pew Forum on Religion and Public Life (conradhackett@gmail.com)

Brian Grim, Pew Forum on Religion & Public Life
Marcin Stonawski, International Institute for Applied Systems Analysis (IIASA) and Cracow University of Economics
Vegard Skirbekk, International Institute for Applied Systems Analysis (IIASA)

Classifying Religiosity in the Adult Population from 1988 to 2010

Eric Tranby, University of Delaware (etranby@udel.edu)

Samantha Zulkowski, University of Delaware

Explaining Changes in Social Capital Trends: Does Religion Matter?

April Clark, Purdue University Calumet (april.clark@purduecal.edu)

A-7. SSSR: Evangelization and Church Growth

Room: Otis

Organizer/Convener: Pierre Hegy, Adelphi University (pmhegy@gmail.com)

The Rise of the New Evangelization: Post-Vatican II to 1992 to 2012
Benjamin Bennett-Carpenter, Oakland University (bbennettcarpenter@gmail.com)

Michael McCallion, Sacred Heart Major Seminary

Young Adults and the New Evangelization in the Archdiocese of Detroit

Michael McCallion, Sacred Heart Major Seminary (mccallion.michael@shms.edu)

A Typology of Networks in Global Evangelicalism

Stephen Offutt, Asbury Theological Seminary (stephen.offutt@asburyseminary.edu)

Missions and Outreach Ministries at an Evangelical Church

Pierre Hegy, Adelphi University (pierre.hegy@gmail.com)

A-8. SSSR: New Religious Movements

Room: Webster

Convener: Jennifer Fagen, Lamar University (profjen@aol.com)

Sacred and Secular: Is the Universal Life Church a New Religious Movement?

Dusty Hoesly, University of California, Santa Barbara (dusty.hoesly@gmail.com)

Government Raids in France, 1989-2011: The Social Control of Religious Minorities and Sects

Susan Palmer, Dawson College (spalmer@dawsoncollege.qc.ca)

Stuart Wright, Lamar University, Texas

Reclaiming of the Swastika: The Use of Shock Value in a Religious Symbol

Justin Van Ness, University of Notre Dame (jvanness@nd.edu)

The Late Twentieth Century Transplantation of Soto Zen into Peru: A Processive Analysis

German McKenzie, Catholic University of America (gfmckenzie@gmail.com)

A-9. SSSR: Psychology of Religion and Morality

Room: Burroughs

Organizer: Wade Rowatt, Baylor University (wade_rowatt@baylor.edu)

Convener: Linda Kang, Baylor University (Linda_Kang@baylor.edu)

Moral Foundations and Attitudes toward Arabs and Muslims

Linda Kang, Baylor University (Linda_Kang@baylor.edu)

Logan Yelderman, University of Nevada, Reno

Megan Haggard, Baylor University

Friday, November 8, 8:00-9:30 AM

A-9, cont.

The Role of Rigid Cognitions and Priming Religiosity in Affecting the Relationship Between Religiosity and Moral Intuitions

Megan Johnson Shen, Memorial Sloan-Kettering Cancer Center (shenm@mskcc.org)

"Do All to the Glory of God": The Influence of Religious Beliefs on Evaluations of Secular Behaviors

Larisa Heiphetz, Boston College (larisa.heiphetz@gmail.com)

Elizabeth S. Spelke, Harvard University

Mahzarin R. Banaji, Harvard University

A-10. SSSR: Religion and the Anti-human Trafficking Social Movement

Room: Carlton

Organizer: Kersten Priest, Indiana Wesleyan University (kersten.priest@indwes.edu)

Convener: Hilary Davidson, Notre Dame University (h davidson@nd.edu)

"White Saviors" or "Warm-Hearted Wesleyan College Students"?: A Case Study of Anti-human Trafficking Mobilization.

Kersten Priest, Indiana Wesleyan University (kersten.priest@indwes.edu)

Resources and Opportunities for Awareness and Action: A Catholic University's Response to Human Trafficking

Karen Hooge, Notre Dame University (khooge@nd.edu)

A Case Study of Sex Trafficking Mission Trip Blogs: The Role of Web Media in Connecting Personal Beliefs and Organizational Response

Shelly Isaacs, Baylor University (Shelly.Isaacs@baylor.edu)

A-11. SSSR: European Religious Landscapes

Room: Lewis

Convener: James T. Richardson, University of Nevada, Reno (jtr@unr.edu)

What Establishment and Disestablishment Really Do To Religion: Results from the Swiss National Congregation Study.

Jörg Stolz, University of Lausanne (joerg.stolz@unil.ch)

Mark Chaves, Duke University

Masters of the Local, Experts of the Global: The Relevance of Contemporary Sufism to Postsocialist Society

Mentor Mustafa, Boston University (mentor@bu.edu)

The Value of Autonomy in Europe—Religious Differences and Change Over Time

Ingrid Storm, University of Manchester (ingrid.storm@manchester.ac.uk)

Eastern Orthodoxy and the Politics of Family Policy in Europe

Jerry G. Pankhurst, Wittenberg University (jpankhurst@wittenberg.edu)

A-12. SSSR: Political Engagement

Room: Hancock

Convener: Kevin Dougherty, Baylor University (Kevin_Dougherty@baylor.edu)

Do Substantive Religious Commitments Undermine Democratic Legitimacy?

Michael Evans, Dartmouth College (michael.evans@dartmouth.edu)

Black Religious Leaders on President Barack Obama in a Political Battleground State

Korie Edwards, Ohio State University (kle@sociology.osu.edu)

Political Tolerance and Religion: An Age-Period-Cohort Analysis

Marie Eisenstein, Indiana University Northwest (maeisens@iun.edu)

April Clark, Purdue University Calumet

The Influence of Religion on Political Participation in European Countries: Contextual and Individual Effects

David Sikkink, University of Notre Dame (dsikkink@nd.edu)

Shanna Comer, University of Notre Dame

A-13. SSSR: Religion and Violence

Room: Paine

Convener: Martin Rowe, Boston University (martin.t.rowe@gmail.com)

Gender Violence: Does Religion Fuel it Among Marginalized Women?

Sarah Neeley, University of Denver/Iliff School of Theology (sarah.a.neeley@gmail.com)

Challenging Instrumentalism: Re-examining the Religious Bases (the "Micro") of Communal Violence in South Asia

Autumn Mathias, Northeastern University (mathias.a@husky.neu.edu)

Religion's Complex Role in Suicide and Suicide Attacks

Asif Iqbal (ajaanpk@gmail.com)

Religious Extremism

Farheen Sheikh, University of Baluchistan, Quetta (farheen_sheikh786@hotmail.com)

A-14. SSSR: Religious Identity Construction

Room: Revere

Convener: Christopher L. Chiappari, St. Olaf College (chiappar@stolaf.edu)

The Myth of Multireligiousness: Assessing the (Im-)Possibility of Identification with Multiple Religions

Adam Horowitz, Stanford University (ahorowitz@stanford.edu)

How Religion Affects Identity in Migration: Evangelical International Students as Return Migrants

Jenny McGill, King's College London (j.mcgill@fulbrightmail.org)

Friday, November 8, 9:45-11:15 AM

B-1. SSSR: Author Meets Critics: *When Diversity Drops: Race, Religion, and Affirmative Action in Higher Education*, by Julie J. Park (Rutgers University Press, 2013)

Room: Bulfinch

Organizer/Convener: Ryon Cobb, Florida State University (ryon.cobb@gmail.com)

Discussant: Julie Park, University of Maryland (parkjj@umd.edu)
 Critic: Margarita Mooney, Yale University (margarita.mooney@yale.edu)
 Critic: Jerry Park, Baylor University (Jerry_Park@baylor.edu)
 Critic: Korie Edwards, Ohio State (kle@osu.edu)
 Critic: Kathleen Garces-Foley, Marymount University (kathleen.garces-foley@marymount.edu)

B-2. SSSR: Empirical Approaches to Prayer

Room: Hale

Organizer: Leslie J. Francis, University of Warwick (leslie.francis@warwick.ac.uk)
 Convener: Giuseppe Giordan, University of Padova (giuseppe.giordan@tin.it)

The Cathedral Prayer Board and Ordinary Theology: An Empirical Study for Rural Wales

Tania ap Siôn, University of Warwick (t.apsion@glyndwr.ac.uk)

Prayer and Purpose in Life: An Empirical Enquiry Among Adolescents in the UK

Leslie J. Francis, University of Warwick (leslie.francis@warwick.ac.uk)

Bodies of Power: An African Narrative of Liberation and Transformation.

Annalisa Buttici, Harvard Divinity School (abuttici@hds.harvard.edu)

Praying Between Religion and Spirituality

Giuseppe Giordan, University of Padova (giuseppe.giordan@unipd.it)

B-3. RRA: Workshop: Real-Time Univariate and Multivariate Data Analysis for Decision-Makers

Room: Douglass

Organizer/Convener: Marjorie Royle, Clay Pots Research (claypots@optonline.net)

Large multid denominational and multivariate datasets such as the Faith Communities Today and the U.S. Congregational Life Surveys provide excellent opportunities to explore complex relationships among variables, controlling for differences by denominational or faith family, congregational size, race/ethnicity and other factors. Such analysis requires skills in multivariate analysis. However, such analyses present challenges both in performing them and in communicating the results to denominational executives and others who are not trained in statistical techniques. Using the UniMult statistical program and the FACT 2010 data, this session will demonstrate a way to involve non-statisticians in helping develop and test hypotheses. Attendees will be encouraged to suggest analyses, which will then be performed. This real-time involvement is an effective tool

B-3, cont.

to help decision-makers engage with the data to answer questions relevant to their work.

Panelist: Richard Gorsuch, Fuller Theological Seminary (rgorsuch@fuller.edu)

Panelist: Marjorie Royle, Clay Pots Research (claypots@optonline.net)

B-4. SSSR: Social Welfare and Activism

Room: Griffin

Convener: Madeleine Cousineau, Mount Ida College (mrcousineau@comcast.net)

Transforming Christian Identities in Faith-Based Community Organizing

Michelle Oyakawa, The Ohio State University (oyakawa.4@osu.edu)

Becoming a Progressive Catholic Community: Parish activism in a time of change

Matthew Loveland, Le Moyne College (lovelam@lemoyne.edu)

Information Flows Both Ways: Congregations and Social Welfare Provision

Sarah Garlington, Boston University (sgarling@bu.edu)

Different Means to Different Ends: Amounts of Giving by Methods for Giving

Patricia Snell Herzog, University of Arkansas (psh@rice.edu)

Heather Price, University of Notre Dame

B-5. RRA: Transformation of Religious Communities

Room: Adams

Convener: Marty Smith

Toward A New Construction of Community: History, Development, and Tensions

Elfriede Wedam, Loyola University Chicago (ewedam@luc.edu)

Continuity and Change Among the Amish in America

Andy Borella, University of Turin, Italy (andreaborella@hotmail.it)

Personal Religion, Transformational Leadership, and Organizational Citizenship

Chang-Ho Ji, La Sierra University (cji@lasierra.edu)

Are Multiracial Congregations Calmer?

Adair T. Lummis, Hartford Institute for Religious Research (alummis@hartsem.edu)

David Roozen, HIRR, Hartford Seminary

Scott Thumma, HIRR, Hartford Seminary

B-6. RRA: Understanding Catholic Parishes and Dioceses: Methodologies and Interventions (Catholic Research Forum)

Room: Faneuil

Organizer: Michael Cieslak, Diocese of Rockford (MCieslak@RockfordDiocese.org)

Friday, November 8, 9:45-11:15 AM

B-6, cont.

Convener: Jeff Rexhausen, University of Cincinnati (rexjw@uc-mail.uc.edu)

Discussant: Patricia Wittberg, IUPUI (pwittber@iupui.edu)

The Widow's Mite or the King's Mite?: A Model for Identifying High and Low Performing Catholic Parishes

Michael Cieslak, Diocese of Rockford (MCieslak@RockfordDiocese.org)

How Quickly Do Bishops Become Obsolete: Bishop Tenure and Diocesan Performance

Charles Zech, Villanova Center for the Study of Church Management (charles.zech@villanova.edu)

Parish Mission Capability Matrix

Robert Miller, Archdiocese of Philadelphia (drmiller@adphil.org)

B-7. SSSR: Workshop: Teaching Pluralism

Room: Alcott

Convener: Whitney Barth, The Pluralism Project, Harvard University (wlb356@mail.harvard.edu)

Over the past two decades, the Pluralism Project has documented the changing religious landscape of America. We have studied the ways in which these changes, largely stimulated by the "new immigration" of the post-1965 period, have posed new issues for virtually every public institution in the United States, including all of our educational institutions. At the same time, there has also been increasing research in the field of education documenting the effectiveness of case studies in learning, either as a substitute for or an enhancement of the primarily lecture-based courses that are still the usual fare in many colleges and universities. The Pluralism Project has developed a Case Study Initiative to explore how the case method can be creatively applied to teaching and learning in the classroom. Our basic texts are the issues that arise in the contexts of our civil society, public life, and religious communities.

Participants in this workshop will have the opportunity to engage with their peers in discussion of a Pluralism Project case study and brainstorm together ways in which case studies, as a pedagogical tool, might be integrated into their teaching. Information will also be provided about the Pluralism Project's current collection of case studies and online resources. For more information about the Pluralism Project, please visit www.pluralism.org.

B-8. SSSR: Durkheim and Contemporary Society

Room: Otis

Organizer/Convener/Discussant: Andrew Schaefer, University of New Hampshire (apq62@wildcats.unh.edu)

The Sociology of Fatalism: An Application of Durkheim's Suicide to Issues of Conceptualization and Measurement

Gabriel A. Acevedo, University of Texas, San Antonio (gabriel.acevedo@utsa.edu)

B-8, cont.

A Devotee's Nick-Picking with Durkheim

N. Jay Demerath, University of Massachusetts, Amherst (demerath@soc.umass.edu)

The Resurgence of Durkheim in Connection to the Sacred and the Profane

Simonetta Falasca-Zamponi, University of California, Santa Barbara (falasca@soc.ucsb.edu)

Durkheim and Darwin: References to EFRL in Recent Writings on Human Adaptation

Andrew Stuart Abel, Hastings College (aabel@hastings.edu)

B-9. SSSR: Religious Knowledge, Evolution, and the Nature of Humanity

Room: Webster

Organizer/Convener: Jeffrey Guhin, Yale University (jeffrey.guhin@yale.edu)

Discussant: Micah Roos, University of North Carolina, Chapel Hill (micah.roos@gmail.com)

How Does Religion Work to Mediate the Teaching of Evangelical American Science Teachers?

David Long, George Mason University (dlong9@gmu.edu)

Reception of Biological Evolution: Fluid Science and Religion Boundaries Amongst Muslim Physicians and Medical Students

Salman Hameed, Hampshire College (shameed@hampshire.edu)

What It Means To Be Human: An Empirical Study

John H. Evans, University of California, San Diego (jhevens@ucsd.edu)

The Pragmatic Technology of Science in Muslim and Evangelical Schools

Jeffrey Guhin, Yale University (jeffrey.guhin@yale.edu)

B-10. SSSR: Interactive Online Tools: Uses in Research, Teaching, and Scholarship

Room: Burroughs

Organizer: Juan Carlos Esparza Ochoa, Pew Research Center's Forum on Religion and Public Life (jesparzaocchoa@pewforum.org)

Convener: Lluís Oviedo, Pontificia Università Antoniana (loviedo@antonianum.eu)

PEW-Templeton Global Religious Futures Website and Database Demonstration

Juan Carlos Esparza Ochoa, Pew Research Center's Forum on Religion and Public Life (jesparzaocchoa@pewforum.org)

TEDx Talks: An Example of Research on Religion Making the World a Better Place

Brian Grim, Pew Research Center's Forum on Religion and Public Life (BGrim@PewForum.org)

Friday, November 8, 9:45-11:15 AM

B-10, cont.

World Religion Database and World Christian Database: Academic Rigor with Multi-media Delivery

Todd Johnson, Center for the Study of Global Christianity at Gordon-Conwell Theological Seminary (tjohnson@gordonconwell.edu)

Gina Bellofatto, Boston University: Institute on Culture, Religion and World Affairs (CURA)

B-11. SSSR: Prosociality and Prejudice: Revisiting the Role of Religion

Room: Carlton

Organizer: Wade Rowatt, Baylor University (wade_rowatt@baylor.edu)

Convener: Megan Haggard, Baylor University (Megan_Haggard@baylor.edu)

God and Woman: Religious Priming and Sexism

Megan Haggard, Baylor University (Megan_Haggard@baylor.edu)

Wade Rowatt, Baylor University

Religious Bias in Academia

Zhen Cheng, University of Oregon (zcheng@uoregon.edu)

The Relationship Between Religious Complexity and Prosociality

Carissa Sharp, University of Oregon (csharp@uoregon.edu)

B-12. SSSR: Progressive Religion in the United States: Re-mapping the Political Landscape

Room: Lewis

Organizer: Ruth Braunstein, New York University (ruth.braunstein@nyu.edu)

Convener: Todd Fuist, Loyola University Chicago (tfuist@luc.edu)

Discussant: Rhys Williams, Loyola University Chicago (rwilliams7@luc.edu)

Valuing and Creating Formal Neutrality in Progressive Religious Action

Gary Adler, University of Southern California (gary.adler@usc.edu)

Not Left Wing, Just Human: The Embedded Politics of Religion and Morality

Todd Fuist, Loyola University Chicago (tfuist@luc.edu)

"Joseph and Mary Participated in the Census": Religion and Undocumented Immigrant Substantive Citizenship

Juan Martinez, University of Illinois at Chicago (jmarti3@uic.edu)

The Limits of Congregation-Based Organizing: Buddhist, Hindu and Muslim Activism in the U.S.

Grace Yukich, Quinnipiac University (grace.yukich@quinnipiac.edu)

B-13. SSSR: Pluralism and Religious Ecologies

Room: Hancock

Convener: Carol Ann MacGregor, Loyola University New Orleans (camacgre@loyno.edu)

Hybrid Amish Garb: Plain Meets Fashionable

Cory Anderson, Ohio State University (dranderson@beachyam.org)

B-13, cont.

HIV Prevalence in Religiously Diverse Societies

Jenny Trinitapoli, Penn State University (jennytrini@psu.edu)

Alexander Weinreb, University of Texas at Austin

Demographic and Theological Factors in Successful Multicultural (Religiously Plural) Societies

Gary Bouma, Monash University (gary.bouma@monash.edu)

Defining the Conversation about Shari'a: Representations in Australian and US Newspapers

Adam Possamai, University of Western Sydney (A.Possamai@uws.edu.au)

Bryan Turner, University of Western Sydney and CUNY

Joshua Roose, University of Western Sydney

B-14. SSSR: Religion in China

Room: Paine

Convener: Anna Sun, Kenyon College (suna@kenyon.edu)

Yin Yang: A New Perspective in Understanding the Development of Christian Churches in Modern China

Zoey Lu Qiu, Brigham Young University (ms.2pm@live.com)

How Religious Are the Chinese? An Application of Riesebrodt's Theory of Religion to the Chinese Case

Megan Rogers, University of Notre Dame (mroger10@nd.edu)

Religiously-Based Social Distance in Singapore: Results from First National Survey of Race, Religion and Language

Mathew Mathews, National University of Singapore (mathew.mathews@nus.edu.sg)

B-15. SSSR: Religious Imagery and Objects

Room: Revere

Convener: Roman R. Williams, Calvin College (roman.williams@calvin.edu)

Pilgrimage Souvenirs: Providing Profit and Meaning in the Religious Culture Industry

Robert Reynolds, Weber State University (rreynolds@weber.edu)

Images of God, Embeddedness and Distress

Matt Henderson, Baylor University (Matt_Henderson@baylor.edu)

From Cairo to Tehran: Body, Visuality and Agency

Rezvaneh Ganji, New School for Social Research (Ganjr455@newschool.edu)

Circulation of Religious Images and Objects

Kalashreen Raghavan, Sri Aurobindo Institute of Research in Social Sciences (kalaresearch@gmail.com)

11:30 AM-12:45 PM

**New Member and Awards Lunch, Harbor 2-3
(admission by ticket only)**

Friday, November 8, 1:00-2:30 PM

C-1. RRA: Applying Sociological Research in Religious Settings: Mobilizing a Response to Domestic Violence **Room: Bulfinch**

Organizer/Convener: Steve McMullin, Acadia Divinity College (stephen.mcmullin@acadiau.ca)

Discussant: Kendra Yoder, University of Missouri (klyd@mail.missouri.edu)

Bringing Research Data on Domestic Violence to Life: Storytelling as a means of engaging the non-academic audience

Barbara Fisher-Townsend, University of New Brunswick (barbft@unb.ca)

Immigrant Women: Considering their Vulnerabilities and Strengths in a Christian Response to Domestic Violence

Cathy Holtmann, University of New Brunswick (cathy.holtmann@unb.ca)

The Challenge of Teaching About Domestic Violence in a Seminary Setting: Lessons from the Field

Nancy Nason-Clark, University of New Brunswick (nasoncla@unb.ca)

Religious Leaders, Sociological Data, and the Needs of Victims

Steve McMullin, Acadia Divinity College (stephen.mcmullin@acadiau.ca)

C-2. SSSR: Author Meets Critics: The African Christian Diaspora: New Currents and Emerging Trends in World Christianity, by Afe Adogame (Bloomsbury Academic, 2013) **Room: Hale**

Organizer/Convener: Afe Adogame, University of Edinburgh (a.adogame@ed.ac.uk)

Discussant: Jim Spickard, University of Redlands (jim_spickard@redlands.edu)

Critic: Dyron Daugherty, Pepperdine University (dyron.daugherty@pepperdine.edu)

Critic: Nimi Wariboko, Andover Newton Theological School (nwari-boko@ants.edu)

Critic: Annalisa Butticci, Harvard Divinity School (abutticci@hds.harvard.edu)

C-3. SSSR: Comparative Perspectives on Generosity **Room: Faneuil**

Convener: Sharon L. Miller, Auburn Theological Seminary (SMiller@auburnseminary.org)

American Congregations and The Great Recession

Shawna Anderson, Duke University (sla15@soc.duke.edu)

Mark Chaves, Duke University

Religion and Everyday Financial Generosity: Results from a Nationally Representative Survey Experiment

Jonathan Hill, Calvin College (jph27@calvin.edu)

Brandon Vaidyanathan, University of Notre Dame

C-3, cont.

The Geography of Giving: "Other-Oriented" vs. "Self-Oriented" Religious Giving by County

Patricia Snell Herzog, University of Arkansas (psh@rice.edu)

Avoiding Sin or Helping Others? How American Christians Understand Communitarian and Individualist Approaches to their Faith

Amanda Friesen, Indiana University-Purdue University at Indianapolis (amfriesen@iupui.edu)

Michael Wagner, University of Wisconsin-Madison

C-4. RRA: Exploring Catholic Youth and Young Adults (Catholic Research Forum) **Room: Douglass**

Organizer/Convener: Michael Cieslak, Diocese of Rockford (MCieslak@RockfordDiocese.org)

Discussant: Michael McCallion, Archdiocese of Detroit (mccallion.michael@aod.org)

Kids Today!: Lifecycle and the Young Adult Catholic

Melissa Cidade, Center for Applied Research in the Apostolate (CARA) at Georgetown (mac288@georgetown.edu)

Mark Gray, CARA at Georgetown

Mary Gautier, CARA at Georgetown

What Happens After SHINE? Longitudinal Study of Retreat Leaders from Catholic Schools

Richard Rymarz, St Joseph's College, University of Alberta (rymarz@ualberta.ca)

Moral and Religious Values of Nigerian Youths in Their Use of Online Social Networks

Victor Amole, Ph.D. researcher, Alfonsianum Institute, Rome (bim-boamole@yahoo.com)

Luis Oviedo, Antonianum University, Rome

C-5. SSSR Presidential Panel: How Religion Works: Disciplinary Perspectives and Bridges **Room: Griffin**

Organizer: Michele Dillon, University of New Hampshire (michele.dillon@unh.edu)

Convener: Paul Wink, Wellesley College (pwink@wellesley.edu)

Panelist: Laurence Iannaccone, Chapman University (larry@econzone.com)

Panelist: Gerardo Marti, Davidson College (gemarti@davidson.edu)

Panelist: Doug Oman, University of California, Berkeley (dougoman@post.harvard.edu)

Panelist: Ann Taves, University of California at Santa Barbara (taves@religion.ucsb.edu)

Friday, November 8, 1:00-2:30 PM

C-6. RRA: Relationships Among Communities Religious and Other

Room: Adams

Convener: Laura Olson (laurao@clemson.edu)

Ecology of Religious Conflict: Cross-National Comparison of Violent Attacks

Katharine Boyd, John Jay College of Criminal Justice, CUNY, Graduate Center (katharine.a.boyd@gmail.com)

Theism, Sexual Politics, and Sex Education in Public Schools: The Case of the American States

Joseph Baker, East Tennessee State University (bakerjo@etsu.edu)
Smith Kelli, East Tennessee State University

Defeating Death with Dignity: A New Political Path for the Catholic Church

Maurice Cunningham, University of Massachusetts at Boston (maurice.cunningham@umb.edu)

Collaboration Between Religious Groups—Struggles of Conservative Christian Clergy in Singapore

Mathew Mathews, National University of Singapore (mathew.mathews@nus.edu.sg)

C-7. SSSR: Seeing Religion: Visual Research Methods I

Room: Alcott

Organizer: Roman R. Williams, Calvin College (roman.williams@calvin.edu)

Convener: Janet Jacobs, University of Colorado at Boulder (janet.jacobs@colorado.edu)

Toward a Visual Sociology of Religion

Roman R. Williams, Calvin College (roman.williams@calvin.edu)

Visualizing an Urban Ecology: Spatial Approaches to Studying Social Contrasts

Katie Day, Lutheran Theological Seminary (kday@ltsps.edu)

Mapping Congregational Responses to Re-Urbanization and Gentrification

Mark Mulder, Calvin College (mmulder@calvin.edu)

C-8. SSSR: Issues and Methods in Religious Self-Identification

Room: Otis

Organizer/Convener: Abby Day, University of Kent (afday@btinternet.com)

Discussant: Charles Kadushin, Cohen Center for Modern Jewish Studies (kadushin@brandeis.edu)

Correcting the Religious Response: How Qualitative Research Influenced the UK 2011 Census Design and Results

Abby Day, University of Kent (afday@btinternet.com)

The Challenges of Measuring Religious Identity, with Many Examples

Conrad Hackett, Pew Research Center's Forum on Religion & Public Life (conradhackett@gmail.com)

C-8, cont.

The Role of Religion in the Everyday Life of Young People

Ariela Keysar, Institute for the Study of Secularism in Society and Culture (ariela.keysar@trincoll.edu)

Religion as a Resource for Youth? Experiences from a Swedish Research Project

Mia Lovheim, Uppsala University (mia.lovheim@teol.uu.se)

Maria Klingenberg, Uppsala University

C-9. SSSR: California Religion: Does the Difference Make a Difference?

Room: Webster

Organizer: Richard Flory, University of Southern California (rflory@usc.edu)

Past Meets Present: The Religious Landscape of California

Bruce Phillips, Hebrew Union College (baphucusc@gmail.com)

The New Social Gospel: Trickle Down and Bottom Up Christianity

Brad Christerson, Biola University (bradley.christerson@biola.edu)

Richard Flory, University of Southern California

The Religious Landscape of Seoul Metropolitan Area: A Comparison with California

Sung Gun Kim, Seowon University (sgkim@seowon.ac.kr)

Jae-ryong Song, Kyung Hee University (jrsong@khu.ac.kr)

Kwang Suk Yoo, Seoul National University (ksyooii@snu.ac.kr)

C-10. SSSR: New Approaches to Religious Conversion

Room: Burroughs

Organizer/Convener: Henri Gooren, Oakland University (gooren@oakland.edu)

Hispanic Muslim Converts in Metropolitan DC and New Jersey: Understanding the Nature of Conversion

Victor Cuartas, Regent University (victcua@regent.edu)

The Sociology of Religion and the "Multilevel Interdisciplinary Paradigm" in Conversion Research

Ines Jindra, University of Notre Dame (ijindra@nd.edu)

Raymond Paloutzian, Westmont College

Converging to the Norm: From "Wild" to "Cultivated" Channeling

Adam Klin-Oron, Hebrew University of Jerusalem (adamk@vanleer.org.il)

C-11. SSSR: Twenty-five Years of Desecularization in Russia: Outcomes and Prospects

Room: Carlton

Organizer: Vyacheslav Karpov, Western Michigan University (v.karpov@wmich.edu)

Convener: Elena Lisovskaya, Western Michigan University (lisovskaya@wmich.edu)

Friday, November 8, 1:00-2:30 PM

C-11, cont.

The Outcomes and Prospects of Russia's Desecularization, 1988-2013

Vyacheslav Karpov, Western Michigan University (v.karpov@wmich.edu)

The Social Dynamics and Outcomes of Desecularization of Russia's State-run Schools

Elena Lisovskaya, Western Michigan University (lisovskaya@wmich.edu)

The Formation and Nature of Russia's Desecularizing Regime

Rachel Schroeder, Western Michigan University (rachel.l.schroeder@wmich.edu)

The Desecularization of the Russo-Chechen Conflict

Christopher Marsh, School of Advanced Military Studies (chrostopher.marsh5@gmail.com)

C-12. SSSR: How Does Religion Work in the Processes of Virtue Development and Moral Formation?

Room: Lewis

Organizer/Convener: Sarah A. Schnitker, Fuller Theological Seminary, School of Psychology (sschnitker@fuller.edu)

Relational Spirituality, Forgiveness, and Humility: Empirical Findings on Pathways and Barriers

Steven J. Sandage, Boston University (ssandage@bu.edu)

Peter J. Jankowski, Bethel University

Sarah Crabtree, Bethel University

The Effects of Imbuing Virtue Development Activities with Spiritual Meaning: Self-Control and Patience Interventions in Adolescents

Sarah A. Schnitker, Fuller Theological Seminary, School of Psychology (sschnitker@fuller.edu)

Prayer Practices and Gratitude: Comparing Gratitude Journaling to Prayers of Gratitude and Thanksgiving

Kelsy Richardson, Fuller Theological Seminary, School of Psychology (kelsyrichardson@fuller.edu)

Sarah A. Schnitker, Fuller Theological Seminary, School of Psychology

Crafting "Capacities of Mind and Heart": A Moral Intuitionist Approach to Religious Practices

G. Michael Leffel, Point Loma Nazarene University (michaelleffel@pointloma.edu)

Abigail M. Shepherd, Fuller Theological Seminary, School of Psychology

C-13. SSSR: Parenting, Religion, and Youth

Room: Hancock

Convener: David C. Dollahite, Brigham Young University (David_Dollahite@byu.edu)

Transitions of Family and Faith: Racial Variation in the Effects of Family Transition on the Religious Lives of Adolescents

Melinda L. Denton, University of Texas at San Antonio (melinda.denton@utsa.edu)

C-13, cont.

Boon or Bane? Religious Service Attendance and Positive Functioning for Families with Special-Needs Children.

Andrew Whitehead, Presbyterian Church (U.S.A.) (andrewwhitehead@gmail.com)

Parental Influence and Belief in God Among Youth in the United States

Casey Homan, University of California, Berkeley (caseyhoman@berkeley.edu)

Emerging Adults and the Religious Encounter: Marginality, Community, and the Individual Quest

Matty Lichtenstein, UC Berkeley (mlicht@berkeley.edu)

C-14. SSSR: Religion and Nationalism

Room: Paine

Convener: Marion Maddox, Macquarie University (marion.maddox@mq.edu.au)

The Holy British Monarchy: Remnants of Empire

Norman Bonney, Edinburgh Napier University (norman.bonney@blueyonder.co.uk)

The Roles of Religion in National Legitimation: Judaism and Zionism's Elusive Quest for Legitimacy

Uriel Abulof, Princeton University (uabulof@princeton.edu)

Egyptian Nationalism Pre- and Post-9/11: An Imagined Communities Perspective

Sarah Shah, University of Toronto (sarah.shah@utsa.edu)

Gabriel A. Acevedo, University of Texas San Antonio

Andrea Ruiz, Penn State University

C-15. SSSR: Religious Pluralism: New Theories and Methods

Room: Revere

Convener: Maria Van Ryn, Yeshiva University (riavanryn@gmail.com)

Religious Pluralism: Stimulant or Sedative for Religious Commitment?

Daniel Olson, Purdue University (dolson@purdue.edu)

Miao Li, Purdue University

Paul Perl, Center for Applied Research in the Apostolate (CARA)

Christian America? Religious Pluralism in the 21st Century

Eric Tranby, University of Delaware (etranby@udel.edu)

Samantha Zulkowski, University of Delaware

Brandie Pugh, University of Delaware

Religious Freedom and Pluralism: A Social Scientific Research Agenda

Fenggang Yang, Purdue University (fyang@purdue.edu)

The Impact Of Legal Pluralism on the Rights of Women and Minorities: Re-Evaluating the Effect with a New Quantitative Tool

Mirjam Kuenkler, Princeton University (kuenkler@princeton.edu)

Yüksel Sezgin, Maxwell School of Citizenship and Public Affairs

Friday, November 8, 2:45-4:15 PM

D-1. RRA: Downtown Boston Religious Landmarks Tour and Congregational Library Visit **Room: Lobby**

Organizer: Perry Chang, Jefferson Community and Technical College (perrydchang@gmail.com)
 Convener: Marjorie Royle, Clay Pots Research (claypots@optonline.net)
 Leader: Margaret Bendroth, American Congregational Association (mbendroth@14beacon.org)

Boston has been a center of religious activity for different faith communities for centuries. In this religious landmarks tour and visit to the leading archives and library of U.S. Congregationalism, participants will see landmarks which may include Old South Meetinghouse, King's Chapel, Park Street Church, and Boston Common. American Congregational Association Executive Director and historian Margaret Bendroth will lead this 45-minute walking tour, which will begin at 3:00 p.m. at the American Congregational Library at 14 Beacon Street in the Beacon Hill area, and conclude with a tour of the library, providing information on its wealth of on-site and on-line resources for possible future research. Transportation will be provided between the hotel (leaving at 2:45 p.m. at the taxi cab stand) and downtown Boston for a limited number of participants. Others may walk or take a cab down Summer Street towards downtown.

D-2. SSSR: Author Meets Critics: *Wake Up, Lazarus! Volume II: Paths to Renewal*, by Pierre Hegy (iUniverse, 2013) **Room: Bulfinch**

Organizer/Convener: Anthony Pogorelc, Catholic University of America (pogorelc@cua.edu)

Discussant: Christopher Rupert, Independent Researcher, Society of Jesus (crupert@jesuits.ca)
 Critic: Brita Andercheck, Baylor University (Brita_Andercheck@baylor.edu)
 Critic: Leslie J. Francis, University of Warwick (leslie.francis@warwick.ac.uk)
 Critic: Michael Cieslak, Diocese of Rockford (MCieslak@Rockford-Diocese.org)
 Critic: Meg Wilkes Karraker, University of St. Thomas (mwkarraker@stthomas.edu)

D-3. SSSR: Congregations in America: Findings from the Third Wave of the National Congregations Study **Room: Hale**

Organizer/Convener: Mark Chaves, Duke University (mac58@soc.duke.edu)

Introducing the Third Wave of the National Congregations Study
 Mark Chaves, Duke University (mac58@soc.duke.edu)
 Shawna Anderson, Duke University

Exploring Hispanic-Nominated Congregations in the National Congregations Study
 Jessica Hamar Martinez, Pew Forum on Religion and Public Life (jmartinez@pewresearch.org)

D-3, cont.

Assessing Congregational Efforts to Address HIV: Results from the National Congregations Study
 Malcolm V. Williams, RAND Corporation (mwilliams@rand.org)
 Kathryn Pitkin Derosé, RAND Corporation

The Use of Scripture in American Congregations
 Arthur E. Farnsley II, IUPUI (afarnsle@iupui.edu)
 Philip Goff, IUPUI
 Peter Thuesen, IUPUI

D-4. RRA: Personal Transformation Inside and Outside of Religious Communities **Room: Faneuil**

Convener: Rich Houseal, Research Services, Church of the Nazarene Global Ministry Center

Religious Faith and Transformational Processes in Marriage
 David C. Dollahite, BYU - School of Family Life (david_dollahite@byu.edu)
 Michael Goodman, Brigham Young University
 Loren Marks, Louisiana State University

Bonds of Fellowship: Community and Belonging in a Large Congregation Church
 Andrew Gruis, University of Northern Iowa (andrewjohn@gmail.com)

Religiosity and Religious Initiatives in Rural Mexico: How Women Effect Change
 Anne Woodrick, University of Northern Iowa (anne.woodrick@uni.edu)

Lived Religiosity and Women's Street Survival
 Sarah Neeley, University of Denver/Iliff School of Theology (sarah.a.neeley@gmail.com)

D-5. RRA: Protestant Church Growth and Decline in Canada **Room: Douglass**

Organizer/Convener: David Haskell, Wilfrid Laurier University (dhaskell@wlu.ca)

Religious Characteristics of Congregants in Declining and Growing Mainline Churches in Canada
 Stephanie Burgoyne, Wilfrid Laurier University (sburgoyne@wlu.ca)
 David Haskell, Wilfrid Laurier University
 Kevin Flatt, Redeemer University College

"Why Do Some Churches Grow and Others Don't?" Mainline Clergy and Congregants' Perspectives on Church Growth and Decline in Canada
 Kevin Flatt, Redeemer University College (kflatt@redeemer.ca)
 David Haskell, Wilfrid Laurier University

Distinctive Traits of the Clergy and Worship Services of Growing and Declining Mainline Congregations in Canada
 David Haskell, Wilfrid Laurier University (dhaskell@wlu.ca)
 Kevin Flatt, Redeemer University College
 Stephanie Burgoyne, Wilfrid Laurier University

Friday, November 8, 2:45-4:15 PM

D-5, cont.

Evangelical Denominational and Congregational Growth in Canada
Sam Reimer, Crandall University (Sam.Reimer@crandallu.ca)

D-6. SSSR: Seeing Religion: Visual Research Methods II Room: Alcott

Organizer/Convener: Roman R. Williams, Calvin College (rrw@me.com)

Seeing Islam in Global Cities: A Spatial Semiotic Analysis
Jerome Krase, Brooklyn College CUNY (jerrykrase@aol.com)
Timothy Shortell, Brooklyn College CUNY

International Holocaust Day in Germany, Spain, and the United States: A Videographic Analysis
Marlen Rabl, University of Bayreuth (marlen.rabl@googlemail.com)
Bernt Schnettler, University of Bayreuth
Alejandro Baer, University of Minnesota

Visual Sociology as Engaged Scholarship: Researching and Addressing Domestic Violence
Cathy Holtmann, University of New Brunswick (cathy.holtmann@unb.ca)
Nancy Nason-Clark, University of New Brunswick

D-7. SSSR: Workshop: From Dissertation to Book Room: Griffin

Organizer: Michele Dillon, University of New Hampshire (michele.dillon@unh.edu)

Peter Mickulas, Rutgers University Press (mickulas@rutgers.edu), will discuss helpful strategies and the pitfalls to be avoided in revising a dissertation and writing an academic book. Audience participation strongly encouraged.

D-8. SSSR: Health Outcomes Room: Adams

Convener: Gail Cafferata, Boston University (revgailc@gmail.com)

Faith, Spirituality, Religion, and Autism
Susan Sullivan, College of the Holy Cross (ssulliva@holycross.edu)
Religion and Obesity Among Adults in Brazil
Ana Paula Verona, Universidade Federal de Minas Gerais, Brazil (anapaulaverona@gmail.com)
Brunah Schall, Universidade Federal de Minas Gerais, Brazil
Claudio Santiago Dias Jr, Universidade Federal de Minas Gerais, Brazil

The Efficacy and Mechanism of Religious Healing
Amy Voorhees, University of California, Santa Barbara (amybv@me.com)

Religiosity, Health Outcomes and Health Care Utilization Among Israeli Jews
Ephraim Shapiro, Columbia University (eas97@columbia.edu)
Shuli Brammli-Greenberg, Myers-JDC-Brookdale Institute
Jacob Glazer, Tel Aviv University

D-9. SSSR: Religion and Race Room: Otis

Convener: Jerry Pankhurst, Wittenberg University (jpankhurst@wittenberg.edu)

Evangelicalism and the Paradox of Racial Stereotypes Among Anglo Americans
Ryon Cobb, Florida State University (ryon.cobb@gmail.com)

The Conflation of Race and Ethnicity and its Relationship with Intolerance and Xenophobia: A Case Study in Contemporary Russia
David Barry, Indiana University-South Bend (david.m.barry@wmich.edu)

The One Friend Rule and Social Deficits: The Impact of Race on Social Capital Development in an Interracial Church
Chris Munn, The Ohio State University (munnn.29@osu.edu)

"Church" in Black and White: The Organizational Lives of Young Adults
Rhys Williams, Loyola University Chicago (rwilliams7@luc.edu)
Courtney Irby, Loyola University Chicago
R. Stephen Warner, University of Illinois at Chicago (rswarner@uic.edu)

D-10. SSSR: Changing Demographics and Strategies of Catholics and Protestants in Latin America Room: Webster

Organizer: Christopher L. Chiappari, St. Olaf College (chiappar@stolaf.edu)
Convener: Henri Gooren, Oakland University (gooren@oakland.edu)

Evangelical Marches in Mexico as Public Expressions of Social Identity
Carlos Garna, Universidad Autónoma Metropolitana (ganc@xanum.uam.mx)

Hegemony of the Catholic Church and Religious Diversity in Mexico: Historical Demographical Analysis of over 100 Years of Data
Juan Carlos Esparza Ochoa, Pew Research Center (jesparza-choa@pewforum.org)
Robert Woodberry, National University of Singapore
Maria Concepcion Servin Nieto, Universidad Nacional Autónoma de México
Melissa Araceli

Deja Vu All Over Again?: A Preferential Option for the Latin American Poor, Part II
Andrew Chestnut, Virginia Commonwealth University (rachesnut@vcu.edu)

Friday, November 8, 2:45-4:15 PM

D-11. SSSR: Contemporary Paganism

Room: Burroughs

Organizer/Convener: Helen Berger, Brandeis University (haberger@brandeis.edu)

Magical and Metaphysical Practices Among Contemporary Pagans
Helen Berger, Women's Studies Research Center, Brandeis University (haberger@brandeis.edu)

Religion and Theology: A Contemporary Western Pagan Perspective on Identity Formation and Modern Policy.

Michael York, Bath Spa University (exchange@michaelyork.co.uk)

Not Just a Religion of Converts: Next Generation Pagans

Laura Wildman-Hanlon, UMass Amherst (lwildman@psych.umass.edu)

Julie Fennell, Gallaudet University

D-12. SSSR: Drugs, Alcohol, and Addiction

Room: Carlton

Convener: Barbara Fisher-Townsend, University of New Brunswick (barbft@unb.ca)

Warring Selves: Cognitive Models of Addiction and Religious Conversion

Jennifer Hahn, UCSB (jenniferlhahn@gmail.com)

Religious Proscription of Alcohol Use and its Impact on the Relationship Between Moderate Drinking and Mortality

R. David Hayward, University of Michigan (rdhaywar@umich.edu)

Neal Krause, University of Michigan

Religiosity, Marijuana Use, and Binge Drinking: The Role of Context and Dimensions of Faith

Craig Rivera, Niagara University (cjr@niagara.edu)

Contemporary Meaning(s) of Penance

Fernando Linhares, Drew University (flinhare@drew.edu)

D-13. SSSR: Fertility and Religion

Room: Lewis

Convener: Cory Anderson, Ohio State University (dranderson@beachyam.org)

Declining Birthrates Among the Beachy Amish-Mennonites: An Indicator of Assimilation?

Cory Anderson, Ohio State University (dranderson@beachyam.org)

The Influence of Belief in God on Pro-Natalist Attitudes in Slovenia and the Czech Republic

Stephen Cranney, University of Pennsylvania (scranney@sas.upenn.edu)

D-13, cont.

Infertility, Blessings, and Head Coverings: Mediated Practices of Jewish Repentance

Michele Rosenthal, University of Haifa (rosenthal.michele@gmail.com)

Religion and Interracial Fertility

Joshua Tom, Baylor University (joshua_tom@baylor.edu)

D-14. SSSR: Politics in and out of Congregations

Room: Hancock

Convener: Michael Evans, Dartmouth College (michael.evans@dartmouth.edu)

Pulpit Politics: Clergy Crusades, Implied Innuendos, or Nothing at all?

Emily Wurgler, Indiana University (ewurgler@indiana.edu)

Democratic, Religious or Fundamentalist? Public opinion on democratic values in Israel.

Ines Gabel, The Open University (inesga@open.ac.uk)

Michael Hopp, Tel Aviv University

Religion and American Politics from a Global Perspective

Paul Froese, Baylor University (Paul_Froese@baylor.edu)

D-15. SSSR: Comparing Global Religious Contexts

Room: Paine

Convener: Gary Bouma, Monash University (gary.bouma@monash.edu)

Imagined Community?: Evidence from the Islamic Republic of Iran
Yaghoob Foroutan, Mazandaran University/Waikato University (y_foroutan@yahoo.com)

"What God Has Destined for Us": Sectarian/Religious, Structural, and Demographic Predictors of Fatalism and Pessimism in Lebanon

Gabriel A. Acevedo, University of Texas, San Antonio (gabriel.acevedo@utsa.edu)

Diala Ammar, Lebanese American University, Beirut

Amanda Salinas, University of Texas, San Antonio

A Church Cannot Live Without Its People

Kathleen Engebretson, Australian Catholic University (kath.engebretson@acu.edu.au)

D-16. SSSR: Religious Rationalizations

Room: Revere

Convener: Ryan T. Cragun, University of Tampa (ryantcragun@gmail.com)

Women Praying for Women: The Gendered Embodiment of Charismatic Healing Prayer

Peter Althouse, Southeastern University (pfalthouse@seu.edu)

Friday, November 8, 2:45-4:15 PM

D-16, cont.

The Evolution of Fervor

Yuval Laor, University of Tel Aviv (yuvalaor@gmail.com)

The Effect of Pentecostal Illness Experience on Religiosity

Shelly Isaacs, Baylor University (Shelly_Isaacs@baylor.edu)

Religious Beliefs as Post Hoc Rationalizations

Stefaan Blancke, Ghent University (stefaan.blancke@ugent.be)

Maarten Boudry, Ghent University

D-17. SSSR: Civic Organizations and Engagement

Room: Harbor 2

Convener: Afe Adogame, University of Edinburgh (A.Adogame@ed.ac.uk)

Civic Organizations, Religious Organizational Density, and Neighborhood Outcomes

Bryant Crubaug, University of Notre Dame (bcrubaug@nd.edu)

Civic Engagement in Britain: The Role of Religion and Inclusive Values

Ingrid Storm, University of Manchester (ingrid.storm@manchester.ac.uk)

Influence of the Pentecostal and Charismatic Religious Traits on Democratic Political Culture

Carmen Guevara, Instituto Universitario de Opinion Publica (IUDOP) de la Universidad Centroamericana (UCA) (cguevara@uca.edu.sv)

D-18. SSSR: Environmental Attitudes and Behavior

Room: Harbor 3

Convener: Garrett Smith, Kennesaw State University (gsmith@kennesaw.edu)

Pro-Environmental Attitudes in Buddhists and Christians

Andrew Garfield, University of Wisconsin-Madison (amgarfield@wisc.edu)

Colleen Moore, Montana State University-Bozeman

Religious Values as a Predictor of Sustainable Consumption Behaviors: A Cross-Cultural Comparison

Elizabeth Minton, University of Oregon (stickel@uoregon.edu)

Lynn Kahle, University of Oregon

Chung-Hyun Kim, Sogang University

Religion and Community Based Resource Management

Yasha Hartberg, Binghamton University (yasha.hartberg@gmail.com)

Michael Cox, Dartmouth College

Sergio Villamayor-Tomas, Humboldt University

4:30-5:30 PM

SSSR New Book Reception

Harbor 1

hosted by Oxford University Press

5:30-6:30 PM

H. Paul Douglass Lecture

Harbor 2-3

**R. Stephen Warner, University of Illinois at Chicago,
"In Defense of Religion"**

6:30-7:30 PM

RRA Reception

Harbor Ballroom Foyer

7:45 PM-8:30 PM

Honoring the Life and Work of Otto Maduro

Burroughs

**Organizer/Convener: Madeleine Cousineau,
Mount Ida College**

Presenter: Laurel Kearns, Drew University

Presenter: Jim Spickard, University of Redlands

Presenter: Nancy Nason-Clark, University of New Brunswick

Presenter: Madeleine Cousineau, Mount Ida College

8:30 PM-10:00 PM

Catholic Research Network Lecture and Meeting

(all welcome)

Lewis

"Pastoral Restructuring and the Parish Collaboratives," Rev. Paul Soper, Director of the Office of Pastoral Planning, Archdiocese of Boston

Saturday

7:00-7:45 AM SSSR Business Meeting
Lewis

7:00-7:45 AM Continental Breakfast for Graduate Students and Past Presidents
Harbor 3

8:00 AM-NOON Registration
Harbor Foyer

8:00 AM-4:00 PM Book Exhibit
Harbor 1

11:30 AM-12:30 PM Plenary Session: "Is Secularism Working?"
Harbor 2/3
Moderator: Michele Dillon, University of New Hampshire

12:45-1:45 PM RRA Business Meeting
Burroughs

12:45-1:45 PM MSSA Business Meeting
Lewis

5:30-6:15 PM SSSR Presidential Address
Michele Dillon, University of New Hampshire, "Asynchrony in Attitudes toward Abortion and Gay Rights: The Challenge to Values Alignment"
Harbor 2/3

6:15-7:00 PM SSSR Reception
Harbor Foyer

7:00 -7:30 PM: Honoring the Life and Work of Andrew Greeley
Lewis
Convener: Wade Clark Roof, University of California Santa Barbara

7:30 -8:00 PM Honoring the Life and Work of Robert Bellah
Burroughs
Convener: Richard Wood, University of New Mexico

8:00 PM Grad Student Meet-Up in Lobby to Go Out

Saturday, November 9, 8:00-9:30 AM

E-1. SSSR: Author Meets Critics: *What You Don't Know About Religion (but Should)*, by Ryan T. Cragun (Pitchstone Publishing, 2013)
Room: Bulfinch

Organizer/Convener: Rick Phillips, University of North Florida (rphilip@unf.edu)

Critic: Michael Nielsen, Georgia Southern University (mnielsen@georgiasouthern.edu)

Critic: Christopher L. Chiappari, St. Olaf College (chiappar@stolaf.edu)

Critic: Rick Phillips, University of North Florida (rphilip@unf.edu)

Response: Ryan T. Cragun, University of Tampa (ryantcragun@gmail.com)

E-2. SSSR: Catholic Church Professionals
Room: Hale

Convener: Susan A. Eisenhandler, University of Connecticut (susan.a.eisenhandler@uconn.edu)

Profile of U.S. Catholic Bishops 1983-2013

Catherine Hoegeman, Missouri State University (katie.hoegeman@gmail.com)

Ethnicity and Race in Catholic Religious Orders of Women in the U.S.
Mary Johnson, Trinity Washington University (Johnsonma@trinitydc.edu)

Status Devaluation in the Catholic Priesthood Post-Vatican II
Jennifer Le, Texas A&M University (jennyle@tamu.edu)

E-3. SSSR: Conversion and Commitment
Room: Faneuil

Convener: Ana Suarez, Catholic University of Argentina-CONICET (analourdessuarez@gmail.com)

The Impact of Conversion Careers upon Self-Stigma and Economic Functioning

Bobby Lynch, Fuller Theological Seminary (lynchbobby@gmail.com)

Disaffiliation in the Churches of Christ: Who Are the Disaffiliates and Where Are They Going?

Suzanne Macaluso, Abilene Christian University (scfournier@gmail.com)

Brittany Taraba, Abilene Christian University

Lynette Sharp Penya, Abilene Christian University

Becoming a Practitioner: Fostering and Sustaining Commitment in Spiritual Disciplines

Erin Johnston, Princeton University (efjohnst@princeton.edu)

Spirituality vs. Spirituality

Imran Haq Nawaz, Pakistan Institute of Development Economics (ihnawaz@yahoo.com)

Saturday, November 9, 8:00-9:30 AM

E-4. RRA: Empirical Perspectives on Clergy Experience I Room: Douglass

Organizer: Andrew Village, York St. John University (a.village@yorks.ac.uk)

Convener: Leslie J. Francis, University of Warwick (leslie.francis@warwick.ac.uk)

Clergy Experience of the Bible: A Comparison with Laity in the Anglican Communion

Andrew Village, York St John University (a.village@yorks.ac.uk)

Work-related Psychological Wellbeing: Testing the Balanced Affect Model Among Anglican Clergy

Leslie J. Francis, University of Warwick (leslie.francis@warwick.ac.uk)

Patrick Laycock, University of Warwick

Work-related Psychological Health and Psychological Type Among Clergywomen in the Church in Wales

Mandy Robbins, Glyndwr University (m.robbs@glyndwr.ac.uk)

Mapping the Connection Between Psychological Type and Emotional Intelligence Among Anglican Clergy in Wales

John Payne, St Mary's Centre (leslie.francis@warwick.ac.uk)

Leslie J. Francis, University of Warwick (leslie.francis@warwick.ac.uk)

E-5. RRA: Interacting with the Media Room: Griffin

Organizer/Convener: Kevin Dougherty, Baylor University (Kevin_Dougherty@baylor.edu)

Advice from a Journalist

David Briggs, Association of Religion Data Archives (dbriggs@thearda.com)

How to Say What You Mean and Know What You Said

Besheer Mohamed, Pew Forum of Religion and Public Life (BMo-hamed@PewForum.org)

The Twenty-First Century Scholar: Employing Multiple Media to Educate the World

Scott Thumma, Hartford Seminary (sthumma@hartsem.edu)

Teaching the Media

Nancy Ammerman, Boston University (nta@bu.edu)

E-6. SSSR: Minds and Bodies Room: Adams

Convener: Jay Feierman, University of New Mexico (jay.feierman84@gmail.com)

The Biology of Religious Beliefs

Jay Feierman, University of New Mexico (retired) (jay.feierman84@gmail.com)

Why Is Religion Unique to Humans? Tracing the Evolution of Our Hyper-Social Minds

Bethany Heywood, Ashford University (bethany.heywood@ashford.edu)

E-6, cont.

Spiritual Modeling Self-Efficacy: Validation of a Stand-Alone Measure

Doug Oman, University of California, Berkeley, School of Public Health (DougOman@post.harvard.edu)

Thomas G. Plante, Santa Clara University

The Implications of Ricoeurian Hermeneutics for the Scientific Study of Religion: Looking Back at the Segal-Kepnes Debate In Order to Look Forward

Adam Valerio, Temple University (adam.valerio@temple.edu)

E-7. RRA: Pastoral Leaders' Professional Development and Spiritual Formation Room: Alcott

Convener: Deborah Kapp, McCormick Theological Seminary (dkapp@mccormick.edu)

Debt, Default and Devotion

Sharon L. Miller, Auburn Theological Seminary (SMiller@auburn-seminary.org)

Certain Uncertainty: Baptist Reflections of the Search and Call Process

Rev. James Ellis III, At-Large Baptist Clergyman, Writer (jamesellis3@gmail.com)

"Where He Leads Me, I Will Follow": Why Individuals Decide To Start Churches

Richard Pitt, Vanderbilt University (r.pitt@vanderbilt.edu)

Ministering to Religiously "Others": Orthodox Christian Chaplains in US Military

Alexei Krindatch, Assembly of Canonical Orthodox Bishops in North and Central America (Akrindatch@aol.com)

E-8. RRA: Religious Participation of Young Adults Room: Otis

Organizer/Convener: Marjorie Royle, Clay Pots Research (clay-pots@optonline.net)

Discussant: Warren Bird, Leadership Network (warren.bird@lead-net.org)

Religious Affiliation at the Intersection of Generation and Gender: A Case Study of American Catholicism

Patricia Wittberg, Sociology Department, IUPUI (pwittber@iupui.edu)

Young Adults and Worship, Digging Deeper

Marjorie Royle, Clay Pots Research (claypots@optonline.net)

Kristina Lizardy-Hajbi, United Church of Christ (hajbik@ucc.org)

Young Adults at Kirkwood United Church of Christ: A FACT Case Study Exploring Factors for Congregational Engagement

Kristina Lizardy-Hajbi, United Church of Christ (hajbik@ucc.org)

Saturday, November 9, 8:00-9:30 AM

E-9. SSSR: Religion and Science I

Room: Webster

Convener: Jaime Kucinkas, Indiana University (jlkucins@indiana.edu)

The Effects of Perceptions of Religion and Nationality on Perceptions of Science and Technology in Five Muslim Majority Nations
Donald Everhart, University of California, San Diego (deverhar@ucsd.edu)

Initial Findings from the National Study of Religion and Human Origins

Jonathan Hill, Calvin College (jph27@calvin.edu)

The Bible and Narratives of Science

Elaine Howard Ecklund, Rice University (ehe@rice.edu)

Esther Chan, Rice University

Paul Abraham, Rice University

Religion, Science, and Law—How People Use Stories in Conversations about Social Controversies

Penny Edgell, University of Minnesota (edgell@umn.edu)

Kathleen Hull, University of Minnesota

Kyle Green, University of Minnesota

Daniel Winchester, University of Minnesota (winch023@umn.edu)

E-10. SSSR: Religion and Public Policies

Room: Burroughs

Organizer/Convener: Solange Lefebvre, University of Montreal (solange.lefebvre@umontreal.ca)

Multiculturalism and Religion: The Strange Case of Britain

James A. Beckford, University of Warwick (J.A.Beckford@warwick.ac.uk)

Threatening Gender Equality: Our Women are Equal, Yours are Oppressed

Lori Beaman, University of Ottawa (lbeaman@uottawa.ca)

Churches and Public Debates on Diversity

Solange Lefebvre, University of Montreal (solange.lefebvre@umontreal.ca)

Religion and Cultural Diversity in Four National Contexts: Defining Minority

Giomny H. Ruiz, University of Montreal (giomny.ruiz.fernandez@umontreal.ca)

E-11. SSSR: Congregations and Networks

Room: Carlton

Convener: Stephen Merino, The University of Texas-Pan American (merinosm@utpa.edu)

The Price of the Calling: Evidence from Panel Data

Cyrus Schleifer, Duke University (cyrus.schleifer@duke.edu)

Mark Chaves, Duke University

E-11, cont.

Congregations, Networks, and Collaboration: The Family Leadership Initiative

Mark Mulder, Calvin College (mmulder@calvin.edu)

Neil Carlson, Calvin College

Network-Embedded Resources Within Urban U.S. Congregations

Kirk Foster, University of South Carolina (kfoster@mailbox.sc.edu)

Popularity, Autonomy and Moral Communities: School Friendship Networks and Religious Change

Nathaniel Porter, The Pennsylvania State University (ndp135@psu.edu)

E-12. SSSR: Dating and Marriage

Room: Lewis

Convener: Brita Andercheck, Baylor University (Brita_Andercheck@Baylor.edu)

A Comparison of Interfaith Marital Stability Predictors Between Advice and Scholarly Literatures

Jennifer (Jenn) Lindsay, Boston University (jlindsay@bu.edu)

Individualism and Marriage: Ideal Types for Making Sense of the Relationship Between Self and Sacrifice

Karen Hooze, University of Notre Dame (khooze@nd.edu)

Mary Ellen Konieczny, University of Notre Dame

Elaxis Ellis, University of Notre Dame

Timing and Types of Union Among Protestant Women in Brazil

Ana Paula Verona, Universidade Federal de Minas Gerais, Brazil (anapaulaverona@gmail.com)

Paula Miranda-Ribeiro, Universidade Federal de Minas Gerais, Brazil

Dimitri Fazito, Universidade Federal de Minas Gerais, Brazil

The Effect of Religious Salience on Attempting Online Dating

Benjamin Gurrentz, The Pennsylvania State University (btg138@psu.edu)

E-13. SSSR: New Media in Varied Religious Contexts

Room: Hancock

Convener: Steve McMullin, Acadia Divinity College (stephen.mcmullin@acadiau.ca)

YouTube and the Mediatization of Jewish Ritual Knowledge

Michele Rosenthal, University of Haifa (rosenthal.michele@gmail.com)

Digital Church for the Brokenhearted: Baby Loss and Religion Online

Janel Kragt Bakker, Collegeville Institute for Ecumenical and Cultural Research (71bakker@cardinalmail.cua.edu)

Jenell Paris, Messiah College

Moroccan Shi'ites, Social Media, and Virtual Asylum

Hafsa Oubou, School of Middle Eastern and North African Studies, University of Arizona (oubou@email.arizona.edu)

Saturday, November 9, 8:00-9:30 AM

E-14. SSSR: Religion in Latin America and the Caribbean Room: Paine

Convener: Robert Brenneman, St. Michael's College (rbrenneman@smcvt.edu)

Pentecostalism in Rio de Janeiro: The Faith of the Killable People
Andrew Johnson, Princeton University (aj3@princeton.edu)

Caribbean Pentecostalism: Women in House Churches, Prayer Cells, and Bible Study Groups
Paula Aymer, Tufts University (paula.aymer@tufts.edu)

Indigenous Youth Dialoguing with Pentecostalism
Maria Beldi de Alcantara, Faculty of Medicine-University of Sao Paulo (marialcantara@mac.com)

New Pentecostal Identities in Contemporary Chile
Martin Lindhardt, University of Southern Denmark (lind@sam.sdu.dk)

E-15. SSSR: Secularism and Apostasy Room: Revere

Convener: Dusty Hoesly, University of California, Santa Barbara (dusty.hoesly@gmail.com)

The Loss of Religious or Spiritual Identity in the LGBT+ Population: An Emerging Grounded Theory
Andrew Wood, University of Central Florida (a.wood@knights.ucf.edu)

Dangerous Talk: Disclosing Apostasy from Islam
Simon Cottey, University of Kent (s_cotti@hotmail.com)

Religion and Secularisation in Europe: A Gender Issue? An Analysis Based on Data from the European Values Study, 2008
Veerle Draulans, Tilburg University, NL, KU Leuven, Be (V.J.R.Draulans@uvt.nl)
Wouter De Tavernier, Cesu KU Leuven, Be

E-16. SSSR: New Methodological Approaches Room: Harbor 2

Convener: Melissa Cidade, CARA at Georgetown University (mac288@georgetown.edu)

Identifying Age, Period and Cohort Effects: Are the New Methods Really Better?
Siobhan McAndrew, University of Manchester (siobhan.mcan-drew@manchester.ac.uk)
Siobhan McAndrew, University of Manchester
David Voas, ISER, University of Essex

Why Asking a Question about Religious Behavior Changes the Answer
Philip Brenner, University of Massachusetts Boston (philip.brenner@umb.edu)

E-16, cont.

Exploring the Dimensions of Worldview: Multidimensional Modeling of an Aggregate of Multiple FQS Datasets
Mika Lassander, Abo Akademi University (mika.lassander@abo.fi)

The Faith of Shia Muslims in Iran: A Comparative Analysis Using the Faith Q-Sort
David Wulff, Wheaton College (dwulff@wheatonma.edu)

E-17. SSSR: Theories of Religion in Society Room: Harbor 3

Convener: Scott Draper, The College of Idaho (sdraper51@gmail.com)

Collective Consciousness, Significant Others and a New Framework for the Analysis of Religion and Civil Religion
Niels Reeh, University of Copenhagen (nreeh@hum.ku.dk)

An Updated Conflict Theory of Religion
Don Swenson, Mount Royal University (dswenson@mtroyal.ca)

Heavy Metal Music as a Religion
Anna Rogers, University of South Carolina (rogersa9@email.sc.edu)

The Missing Gender Revolution in the Sociology of Religion
Courtney Irby, Loyola University Chicago (cirby@luc.edu)
Orit Avishai, Fordham University

Saturday, November 9, 9:45-11:15 AM

F-1. SSSR: Authors Meet Critics: *Religion, Politics, and Polarization: How Religiopolitical Conflict Is Changing Congress and American Democracy*, by William V. D'Antonio, Steven A. Tuch, and Josiah R. Baker (Rowman & Littlefield Publishers, 2013)

Room: Douglass

Organizer/Convener: Mary Gautier, CARA at Georgetown University (gautierm@georgetown.edu)

Critic: N. Jay Demerath, University of Massachusetts (demerath@soc.umass.edu)

Critic: Laura Olson, Clemson University (laurao@clemson.edu)

Critic: Pierre Hegy, Adelphi University (pierre.hegy@gmail.com)

F-2. RRA: Attitudes of People Inside and Outside of Religious Communities

Room: Hale

Convener: Jack Marcum

Predictors of Gender Role Attitudes in Religious Contexts

Suzanne Macaluso, Abilene Christian University (scfourmier@gmail.com)

Lynette Sharp Penya, Abilene Christian University

Dylan Brugman, Abilene Christian University

Why "Strong" Catholic Identity is at a Four-Decade Low in U.S. while "Strong" Protestant Identity is at a Four-Decade High

Conrad Hackett, Pew Forum on Religion and Public Life (conrad-hackett@gmail.com)

Doubting Thomases: Characteristics of Doubters vs Non-doubters

Ida J. Smith-Williams, Research Services Presbyterian Church (Ida.Smith-Williams@pcusa.org)

Culture Skirmishes: Moral Authority as a Frame for Measuring the Interaction of Religion and Politics in Shaping Moral Attitudes

Bob Thomson, Baylor University (Bob_Thomson@baylor.edu)

F-3. SSSR: Biological and Evolutionary Aspects of Religion (BEAR) I

Room: Faneuil

Organizer: Jay Feierman, University of New Mexico (retired) (jay.feierman84@gmail.com)

Convener: Thomas Ellis, Appalachian State University (ellistb@apstate.edu)

Religion as a Cultural Response to Childhood Trauma

Benjamin Abelow, (benjamin.abelow@gmail.com)

Religion: A Biological, Evolutionary and Cognitive Approach

Stewart Guthrie, Fordham University (Emeritus) (guthrie@fordham.edu)

Religion, Ethical Responsibility and Environmental Stewardship in Small-Scale Societies

Burgess Wilson, Rush Medical College (burgess_c_wilson@rush.edu)

F-3, cont.

fMRI and the Future of Religious Studies

Michael McGuire, University of California, Los Angeles, Emeritus (mmcguire@snowcrest.net)

F-4. RRA: Empirical Perspectives on Clergy Experience II

Room: Bulfinch

Organizer: Andrew Village, York St. John University (a.village@yorks.ac.uk)

Convener: Leslie J. Francis, The University of Warwick (leslie.francis@warwick.ac.uk)

How Anglican Clergy in England Conceptualise and Talk about Personal Stress and Professional Burnout

Tania ap Siôn, St Mary's Centre (t.apsion@glyndwr.ac.uk)

Re-Shaping God's Will: Religion and Spirituality Among Former Catholic Priests

Giuseppe Giordan, University of Padova (giuseppe.giordan@unipd.it)

The Relationship Between Injunctions and Personality Pathologies in Clinical Populations of Catholic Clergy, Religious and Lay People

Giuseppe Crea, Salesian University (creagiuse@gmail.com)

A Case Study in Psychotherapy: Sister Ann

Fabrizio Mastrofini, Vatican Radio (Vatican State) (fmastrofini@libero.it)

F-5. SSSR: Leadership and Change in the Catholic Church

Room: Griffin

Convener: Matthew Loveland, Le Moyne College (lovelam@lemoyne.edu)

Once a Catholic, Always a Catholic

Christopher Carroll, Northwestern University (christophercarroll@u.northwestern.edu)

When the Bishops Said "No": Religion and Resistance in France During the Holocaust

Aliza Luft, University of Wisconsin-Madison (alizaluft@gmail.com)

Urbanization as Interaction Between Catholicism and Local Society: St. Ignatius Cathedral, Shanghai City, People's Republic of China

Yun Chen, East China Normal University (achyllus@gmail.com)

Leadership Characteristics and Responses to Diversity: Catholic Bishops' Use of "Personal Parishes"

Catherine Hoegeman, Missouri State University (katie.hoegeman@gmail.com)

Tricia Bruce, Maryville College (tricia.bruce@maryvillecollege.edu)

Saturday, November 9, 9:45-11:15 AM

F-6. RRA: Teaching with the Association of Religion Data Archives

Room: Adams

Organizer/Convener: Kevin Dougherty, Baylor University (Kevin_Dougherty@baylor.edu)

The ARDA Leaning Center: An Overview

Kevin Dougherty, Baylor University (Kevin_Dougherty@baylor.edu)

Virtual Religion: Using YouTube to Teach about Religion

Jennifer McClure, Penn State University (jmm6223@psu.edu)

ARDA Lesson Plans: The Elementary Forms of Religion Syllabi

Andrew Whitehead, University of Mobile (awhitehead@umobile.edu)

'Duh' Science vs. 'Huh' Science: Using the ARDA to Explore Research Methods

Jennifer McKinney, Seattle Pacific University (mckinj@spu.edu)

F-7. SSSR: Religion and Gender Roles

Room: Alcott

Convener: Georgie Weatherby (weatherb@gonzaga.edu)

Conservative Protestant Ethics and Female Labor Force Participation

Jonathan May, Saint Augustine's University (jonmay42@gmail.com)

Women in Leadership Within Evangelical Institutions

Amy Reynolds, Wheaton College (amy.reynolds@wheaton.edu)

Alyssa Norbeck, Wheaton College

Elizabeth Brady, Wheaton College

MENA Muslim Migrant Women: Residing in the West, Committed to the East?

Yaghoob Foroutan, Mazandaran University/Waikato University (y_foroutan@yahoo.com)

Linda Briskman, Swinburne University of Technology, Australia

F-8. SSSR: Innovative and Faithful Measures of Religion

Room: Otis

Organizer/Convener/Discussant: Roger Finke, Pennsylvania State University (rfinke@psu.edu)

Survey Items Revisited: New Designs for Evaluating Survey Measures

Benjamin Gurrentz, Pennsylvania State University (BTG138@psu.edu)

Customers Who Prayed This Also Prayed: Using Amazon.com Book Buying Networks to Investigate Patterns of Religious Interests

Nathaniel Porter, Pennsylvania State University (ndp135@psu.edu)

Creating a Measurement Wizard on the ARDA.com

Christopher Bader, Chapman University (bader@chapman.edu)

F-8, cont.

Deus ex Machina: Cultivating Cooperation with False Attributions of Agency under Uncertainty

Laurence Iannaccone, Chapman University (larry@econzone.com)

Christopher Bader, Chapman University

F-9. SSSR: Twenty-Five Years On: Inform and the Study of New Religious Movements

Room: Webster

Organizer/Convener: James A. Beckford, University of Warwick (J.A.Beckford@warwick.ac.uk)

"Informing" the Public—with the Scientific Study of Religion

Eileen Barker, London School of Economics (e.barker@lse.ac.uk)

If There Had Been No INFORM: Imagining a Tragedy

J. Gordon Melton, Baylor University (jgordon_melton@baylor.edu)

Researching New Religions While Avoiding/Defining "Harm" in a Controversial Field: Tiptoeing Between "Cults", Anti-Cultists and Research Ethics Boards

Susan Palmer, Concordia University (spalmer@dawsoncollege.qc.ca)

The Judicialization of Religious Freedom

James T. Richardson, University of Nevada Reno (jtr@unr.edu)

F-10. SSSR: Understanding the "Nones"

Room: Burroughs

Convener: Stephen Merino, The University of Texas-Pan American (merinosm@utpa.edu)

Apostasy from and Retention to Religion of Socialization in the United States, 1972-2012

Joseph Baker, East Tennessee State University (bakerjo@etsu.edu)

Buster Smith, Catawba College

Beyond the "No Religion" Panic in the United States:

Reginald Bibby, University of Lethbridge (bibby@uleth.ca)

Variation in World-Views Amongst the Members of Finnish Non-Religious Movements

Janne Kontala, Abo Akademi (jkontala@abo.fi)

Mika Lassander, Abo Akademi

Gender and Religious Non-Affiliation: Are Women "Nones" Distinctive?

Carol Ann MacGregor, Loyola University New Orleans (camacgre@loyno.edu)

Saturday, November 9, 9:45-11:15 AM

F-11. SSSR: Toward an Understanding of the Psychological and Economic Impact of Conversion Careers in Latin America **Room: Carlton**

Organizer: Bobby Lynch, Fuller Theological Seminary (lynchbobby@gmail.com)

Convener/Discussant: Donald Miller, Center for Religion and Civic Culture (demiller@dornsife.usc.edu)

The Conversion Careers Approach: Tracing Patterns of Change in Faith Practices

Henri Gooren, Oakland University (gooren@oakland.edu)

The Impact of Conversion Careers upon Self-Stigma and Economic Functioning

Bobby Lynch, Fuller Theological Seminary (lynchbobby@gmail.com)

Assessing the Impact of Conversion Careers

Thomas Felke, Fuller Theological Seminary (tjfinca@gmail.com)

Bobby Lynch, Fuller Theological Seminary

First Impressions from a Longitudinal Study of Central American Gang Converts

Robert Brenneman, St. Michael's College (rbrenneman@smcvt.edu)

F-12. SSSR: Immigrant Incorporation

Room: Lewis

Convener: Phillip Connor, Pew Forum on Religion and Public Life (pconnor@pewforum.org)

Immigrant Women, Religion and Social Networks: Findings from the East Coast of Canada

Cathy Holtmann, University of New Brunswick (cathy.holtmann@unb.ca)

Remaining Catholic: Exploring Filipino American Religious Affiliation Patterns

Stephen M. Cherry, University of Houston Clear Lake (scherry@flash.net)

Majority vs. Minority Religious Status in India and Homeland-Oriented Activism in the United States

Prema Kurien, Syracuse University (pkurien@syr.edu)

Socioeconomic Mobility of Jewish Immigrants in the Twentieth Century

Rachel Ellis, University of Pennsylvania (rhellis@sas.upenn.edu)

Kristin Geraty Bonacci, North Central College (kgeratybonacci@noctrl.edu)

Stephen Viscelli, Swarthmore College (sviscel1@swarthmore.edu)

Melissa Wilde, University of Pennsylvania (mwilde@sas.upenn.edu)

F-13. SSSR: Public Partnerships and Social Welfare

Room: Hancock

Convener: Gabriel A. Acevedo, University of Texas, San Antonio (gabriel.acevedo@utsa.edu)

"This Is Our City": Jesus, Justice, and the Evangelical Turn to Urban America

Wes Markofski, University of Wisconsin-Madison (wmarkofs@ssc.wisc.edu)

F-13, cont.

I Am My Brother's Keeper: Restorative Justice and the Evangelical Experience

Jennifer Marson, Western Michigan University (jennifer.j.marson@wmich.edu)

Pragmatic Pluralism and the Law: A Right to Freedom of Religion in Australia

Charlotte Baines, Monash University (charlotte.baines@monash.edu)

F-14. SSSR: Religion and Aging

Room: Paine

Convener: William H. Swatos, Baylor University (William_Swatos@baylor.edu)

Elderly Christian Women: Survivors, Soldiers, Sustainers

Abby Day, University of Kent (afday@btinternet.com)

Blossoms in Crevices: Faith in Later Life

Susan A. Eisenhandler, University of Connecticut (susan.a.eisenhandler@uconn.edu)

Do Marriage and Childrearing Bring Young Adults Back to Religion?

Jeremy Uecker, Baylor University (jeremy_uecker@baylor.edu)

Damon Mayrl, Universidad Carlos III de Madrid

Samuel Stroope, Louisiana State University

F-15. SSSR: Social Capital and Social Networks

Room: Revere

Convener: Autumn Mathias, Northeastern University (mathias.a@husky.neu.edu)

The Impact of Religious and Social Class Differences on the Academic Experiences of Students at a Catholic University

William Mirola, Marian University (Mirola@marian.edu)

Network Closure and Religious Certainty

Jason Wollschleger, Whitworth University (jason.etc@gmail.com)

Social Capital and Muslim Social Integration in Canada

Jonas Hart, University of Virginia (jonas.hart@virginia.edu)

Information Network Analysis Meets Islamic Studies: Case Study from the Analysis of the Hadith Literature

Muhammad Aurangzeb Ahmad, University of Minnesota (mahmad@cs.umn.edu)

F-16. SSSR: Homosexuality and Sexual Behavior

Room: Harbor 2

Convener: Peter Nynäs, Åbo Akademi University (peter.nynas@abo.fi)

Religion and Sexual Behavior in Two Ghanaian Communities

Jenny Trinitapoli, Penn State University (jennytrini@psu.edu)

William Dawson, Penn State University

Saturday, November 9, 9:45-11:15 AM

F-16, cont.

Clergy Perspectives on Homosexuality and Its Impact on Mental Health Services

John Park, Loma Linda University (jpark1@llu.edu)

Johnny Ramirez-Johnson, Loma Linda University

Public Religions and Same-Sex Marriage

Alpha Possamai-Inesedy, University of Western Sydney (alpha.possamai@uws.edu.au)

Bryan Turner, CUNY; UWS

F-17. SSSR/RRA: Religiosity and Religious Adherence

Room: Harbor 3

Convener: Don Swenson, Mount Royal University (dswenson@mtroyal.ca)

Ancient Graves—Modern Pilgrimages

Anat Feldman, Achva Academic College (afeldman@macam.ac.il)

One Bread, One Body, One Church: The Religiosity of Latino and Anglo Catholics in America

Brita Andercheck, Baylor University (Brita_Andercheck@Baylor.edu)

Testimonios on the Memories and Miracles of Migration

Melissa Guzman, UC Santa Barbara (mguzman@umail.ucsb.edu)

Religious Adherence as a Social Correlate

Dale Jones, Church of the Nazarene Headquarters (djones@nazarene.org)

11:30 AM-12:30 PM

Plenary Session

Harbor 2/3

"Is Secularism Working?"

Moderator: Michele Dillon, University of New Hampshire

Is secularism working? Assessing the place of religion in modernity continues to vex scholars and political commentators, especially as the promises of modernity and of secularism may seem, at times, to fall short of full realization. In this moderated panel, four panelists, working from within different scholarly disciplines and methodologies, will assess the extent to which secularism is doing what it is in part, or wholly, intended to do within and across diverse societal contexts, and probe its impact on religion and society at large.

Panelist: Roger Finke, Penn State University

Panelist: Pippa Norris, Harvard University

Panelist: Genevieve Zubrzycki, University of Michigan

Panelist: Wade Clark Roof, University of California Santa Barbara

12:45-1:45 PM

RRA Business Meeting

Burroughs

12:45-1:45 PM

MSSA Business Meeting

Lewis

Saturday, November 9, 2:00-3:30 PM

G-1. SSSR: Biocultural Approaches to Understanding How Religion Works (BEAR) II

Room: Faneuil

Organizer: Jay Feerman, University of New Mexico (retired) (jay.feerman84@gmail.com)

Convener: Wesley Wildman, Boston University/Co-Editor Religion, Brain and Behavior Journal (wwildman@bu.edu)

Explaining the Stability of High-Cost Religious Groups

Wesley Wildman, Boston University (wwildman@bu.edu)

Richard Sosis, University of Connecticut

Biologically Informed Approaches to the Diffusion of Religious Ideas

Luke Matthews, Activate Networks, Inc., Senior Scientific Director (ljm244@gmail.com)

Explaining Variation in Ritual Participation Among Fijian Horticulturalists: Testing Hypotheses from Life History Theory

John Shaver, University of Connecticut (john.shaver@uconn.edu)

Richard Sosis, University of Connecticut

Religious Rituals Facilitate Group Cohesion by Reducing Status Tensions

Connor Wood, Boston University (connorwood@gmail.com)

Catherine Caldwell-Harris, Boston University

G-2. RRA: Clergy Stress, Psychological Type, and Resilience

Room: Hale

Organizer/Convener: Marjorie Royle, Clay Pots Research (claypots@optonline.net)

An Introduction to Psychological Type

Mandy Robbins, Glyndwr University (mandy.robbs@glyndwr.ac.uk)

Leslie J. Francis, University of Warwick (leslie.francis@warwick.ac.uk)

Can Knowledge about Psychological Type Help Relieve Clergy Stress?

Marjorie Royle, Clay Pots Research (claypots@optonline.net)

Jon Norton, Synod of NY, Reformed Church in America

Tom Larkin, Abundant Life Reformed Church

Psychological Type and Psychological Wellbeing Among Chaplains to the Farming Community in the UK

Leslie J. Francis, University of Warwick (leslie.francis@warwick.ac.uk)

Mandy Robbins, Glyndwr University

G-3. SSSR: Author Meets Critics: *Islamic Feminism in Kuwait: The Politics and Paradoxes*, by Alessandra Gonzalez (Palgrave Macmillan, 2013)

Room: Bulfinch

Organizer: Alessandra Gonzalez, John Jay College, CUNY (alessandra_gonzalez@baylor.edu)

Convener: Paul Froese, Baylor University (Paul_Froese@baylor.edu)

G-3, cont.

Critic: Katherine Meyer, Ohio State University (meyer.23@osu.edu)

Critic: Margarita Mooney, Yale University (margarita.mooney@yale.edu)

Critic: Jeffrey Guhin, Yale University (jeffrey.guhin@yale.edu)

Response: Alessandra Gonzalez, John Jay College, CUNY (Alessandra_Gonzalez@baylor.edu)

G-4. SSSR: Making a Mark on Society: Demographics, Practices and Movements of Catholics (SSSR)

Room: Douglass

Organizer/Convener: Michael Cieslak, Diocese of Rockford (MCieslak@RockfordDiocese.org)

Changing Colors of the Catholic Church: An Examination of the Hispanic Population

Adriana Garcia, Rice University (alg11@rice.edu)

Spirit in the Heartland: Civil Society, Catholic Sisters, and a Good Society

Meg Wilkes Karraker, University of St. Thomas (mwkarraker@stthomas.edu)

Consecrated Life in Argentina: Old and New Forms for Women in the Catholic Church

Ana Suarez, Catholic University of Argentina - CONICET (analourd-essuarez@gmail.com)

Building Stronger Parishes—a Qualitative Study of Catholic Parish Vitality in Australia: Rural Perspectives

Trudy Dantis, Australian Catholic Bishops' Conference - Pastoral Research (t.dantis@pro.catholic.org.au)

G-5. RRA: Tools and Skills for Digital Ministry: Social Media Workshop

Room: Griffin

Organizer: Perry Chang, Jefferson Community and Technical College (perrydchang@gmail.com)

Convener: Ida J. Smith-Williams, Research Services, PC (U.S.A.) (ida.smith-williams@pcusa.org)

Workshop Leader: Rev. Laura E. Everett, Executive Director, Massachusetts Council of Churches (laura@masscouncilofchurches.org)

Perhaps you have tried setting up a Facebook page for your congregation or other religious community and haven't seen much of a response. Or perhaps you want the community to use social media and don't know where to start. This workshop will explain some of the tools religious communities use and help us think about how people of faith can communicate with each other and others through social media. We will explore the differences between broadcast media and social media, help participants become familiar with different social media tools, discuss best practices for pastoral leaders online, and assist in crafting a digital media strategy for your community. This workshop is appropriate for all levels of familiarity with social media.

Saturday, November 9, 2:00-3:30 PM

G-6. SSSR: Religion in College Room: Adams

Convener: William Mirola, Marian University (mirola@marian.edu)

The Devotional Divide: Identity, Values and Voting Among Catholic Millennial College Students
Matt Bahr, Gonzaga University (bahr@gonzaga.edu)

Pathways to Purpose: The Role of Religion in Shaping Meaning and Purpose during College
Jonathan Hill, Calvin College (jph27@calvin.edu)
Perry Glanzer, Baylor University

What's The Trend? The Worldviews and Opinions of American College Students in 2013
Ariela Keysar, Trinity College (akeysar@aol.com)
Barry Kosmin, Trinity College

Religion in College: The Effect of Religion on Cross-Racial Interaction
Julie Park, University of Maryland, College Park (parkjj@umd.edu)
Nicholas Bowman, Bowling Green State University

G-7. SSSR: Effective Collaborative Research Room: Alcott

Organizer/Convener: Kevin Dougherty, Baylor University (Kevin_Dougherty@baylor.edu)

Divided by Space, United by Research: Assessing the Benefits of Collaborative Research Across Campuses
Ryon Cobb, Florida State University (rjc08d@fsu.edu)

Building Student Research Teams in Sociology of Religion—Successes and Failures
Elaine Howard Ecklund, Rice University (ehe@rice.edu)
Esther Chan, Rice University

Thoughts on Developing and Sustaining Collaborative Research Between Faculty and Graduate Students
Christopher Ellison, University of Texas at San Antonio (Christopher.Ellison@utsa.edu)

The Joys, Benefits, and Challenges of Collaborative Research
Corwin Smidt, Calvin College (smid@calvin.edu)

G-8. SSSR: What is "Emerging"? A Workshop on Conceptualizing Social and Religious Change in Post-Boomer America Room: Otis

Organizer: Mark Killian, University of Cincinnati (killiamp@mail.uc.edu)
Convener: Mark Killian, University of Cincinnati (killiamp@mail.uc.edu)

Panelist: Gerardo Marti, Davidson College (gemarti@davidson.edu)
Panelist: James Bielo, Miami University (bielojs@miamioh.edu)
Panelist: Josh Packard, University of Northern Colorado (Josh.Packard@unco.edu)
Panelist: Jason Wollschleger, Whitworth University (jwollschleger@whitworth.edu)

G-9. SSSR: Pentecostal and Charismatic Approaches to Social Change in Latin America Room: Burroughs

Organizer: Christopher L. Chiappari, St. Olaf College (chiappar@stolaf.edu)
Convener: Henri Gooren, Oakland University (gooren@oakland.edu)

Pentecostalization and Politics in Paraguay and Chile
Henri Gooren, Oakland University (gooren@oakland.edu)

Confronting the "Crisis of Values": Violence, Insecurity, and Religion in Guatemala
Robert Brenneman, Saint Michael's College (rbrenneman@smcvt.edu)

Tracing The Wind Of The Spirit: Pentecostal Social Engagement And Human Rights In Pluricultural Guatemala
Matthew Samson, Davidson College (masamson@davidson.edu)

The Organization of Charisma: Networks, Franchises and Spiritual Coverage in Neo-Pentecostal Churches in Guatemala
Chris Chiappari, St. Olaf College (chiappar@stolaf.edu)

G-10. SSSR: Faith, Class, and Space: Geographies of Religion Room: Carlton

Organizer: Justin K.H. Tse, Department of Geography, The University of British Columbia at Vancouver (jtse@geog.ubc.ca)
Convener/Discussant: Ann Taves, Department of Religious Studies, University of California, Santa Barbara (taves@religion.ucsb.edu)

Veiling-Fashion and the Making of an Islamic Bourgeoisie in Turkey
Banu Gökarksel, Department of Geography, University of North Carolina at Chapel Hill (banug@email.unc.edu)
Anna Secor, University of Kentucky

The Dynamics of Class, Religion and Place Amongst Young People in "Deprived Britain"
Elizabeth Olson, Department of Geography, University of North Carolina at Chapel Hill (eaolson@email.unc.edu)
Giselle Vincett, Independent Researcher
Peter Hopkins, Newcastle University
Rachel Pain, Durham University

"We Were Very Orderly and Peaceful": "Model Minority" Evangelicals in Public Space
Justin K.H. Tse, Department of Geography, The University of British Columbia at Vancouver (jtse@geog.ubc.ca)

Saturday, November 9, 2:00-3:30 PM

G-11. SSSR: Gender and Religious Participation

Room: Lewis

Convener: Conrad Hackett, Pew Forum on Religion and Public Life (conradhackett@gmail.com)

Are Women More Religious Than Men? Gendered Narratives of Affiliation, Service and Participation.

Sally K. Gallagher, Oregon State University (sgallagher@oregon-state.edu)

Socially-Constructed Gender Roles and Declining Congregations
Steve McMullin, Acadia Divinity College (stephen.mcmullin@acadiau.ca)

The Nature and Future of the Gender Gap in Religiosity: Evidence from Cross-National European Surveys

David Voas, University of Essex (voas@essex.ac.uk)

Siobhan McAndrew, University of Manchester

Ingrid Storm, University of Manchester

G-12. SSSR: Religion and Happiness

Room: Paine

Convener: Penny Edgell, University of Minnesota (edgell@unm.edu)

Who and Why: The Working Conditions in Church Work Places

Harri Palmu, Church Research Institute, Finland (harri.palmu@gmail.com)

Happiness in Hard Times: Does Religion Protect the Religious?

Orestes 'Pat' Hastings, University of California, Berkeley (ophastings@berkeley.edu)

Religion and Happiness in Turkey

Murat Yilmaz, University of Texas, San Antonio (muratist@mynet.com)

Ahmet Fidan, University of Tennessee

Religious Attendance, Stress, and Happiness in South Korea: The Importance of Gender

Jong Hyun Jung, Purdue University (sociocus75@gmail.com)

G-13. SSSR: Religion and Political Leaders

Room: Revere

Convener: Marion Maddox, Macquarie University (marion.maddox@mq.edu.au)

Discussant: Wade Clark Roof, University of California Santa Barbara (wcroof@religion.ucsb.edu)

God and the Founding Fathers: Images from Prayers in the U.S. Senate

Wendy Cadge, Brandeis University (wcadge@brandeis.edu)

Margaret Clendenen, Brandeis University

Laura Olson, Clemson University

Religion in the U.S. House of Representatives, 1995-2010

James L. Guth, Furman University (jim.guth@furman.edu)

G-13, cont.

Politicisation of Religion in Scandinavian Parliamentary Debates, 1988-2009

Jonas Lindberg, Uppsala University (jonas.lindberg@teol.uu.se)

G-14. SSSR: Memory and Memorialization

Room: Harbor 2

Convener: Daniel Johnson, Gordon College (dan.johnson@gordon.edu)

Too Weird or Just Weird Enough? The Effects of Counterintuitiveness on Theological Concepts

Laird Edman, Northwestern College (ledman@nwcioowa.edu)

Danielle Maurer, Northwestern College

Kirsten McConnel, Northwestern College

Culture Bearing Among Descendants of the Holocaust: Religion and Social Justice Among Children and Grandchildren of Survivors

Janet Jacobs, University of Colorado (jacobsjl@Colorado.edu)

Moral Identity and Moral Injury: How Faith Development Factors into the Experience of Trauma during and after Deployment

David Bell, Georgia State University (davidbell@gsu.edu)

G-15. SSSR: Subcultural Religious Identities

Room: Harbor 3

Convener: Erin Johnston, Princeton University (efjohnst@princeton.edu)

An Analysis of the Amish Model as a Response to the Contemporary Economic Crisis

Andrea Borella, University of Turin (andreaborella@hotmail.it)

What Kinds of Places Attract New Amish Settlements?

Cory Anderson, Ohio State University (dranderson@beachyam.org)

Loren Kenda, Ohio State University

Embattled Dispensationalists

Elliot Berger, Rice University (erb8@rice.edu)

Religious Organizations and Barriers to Outsiders

Scott Draper, The College of Idaho (sdraper51@gmail.com)

G-16. RRA: Prospects for a Critical Sociology of Religion

Room: Hancock

Organizer/Convener: Rhys Williams, Loyola University Chicago (rwilliams7@luc.edu)

Discussant: Michael Puett, Harvard University (puett@fas.harvard.edu)

Lines that Matter, Lines that Don't: Religion, Boundaries, and the Meaning of Difference

Todd Fuist, Loyola University Chicago (tfuist@luc.edu)

Thomas J. Josephsohn, Loyola University Chicago (tjj9q3@gmail.com)

Saturday, November 9, 2:00-3:30 PM

G-16, cont.

Accepting the Post-Colonial Challenge: Theorizing a Khaldūnian Approach to the Marian Apparition at Medjugorje

Jim Spickard, University of Redlands (jim_spickard@redlands.edu)

The Will to Religion: Obligatory Religious Citizenship

Lori Beaman, University of Ottawa (lori.beaman@bell.net)

North American Sociology of Religion: Critique and Prospects

Rhys Williams, Loyola University Chicago (rwilliams7@luc.edu)

Thomas J. Josephsohn, Loyola University Chicago

G-17. RRA: Intercultural Congregations and Social Capital Room: Webster

Organizer/Convener: Mary Gautier, CARA at Georgetown University (gautierm@georgetown.edu)

Integration of Latino Immigrants in Catholic Parishes as a Gateway to Integration into Larger Societal Structures: Emerging Insights from the 2011-2013 National Study of Catholic of Catholic Parishes with Hispanic Ministry

Hosffman Ospino, Boston College (hosffman.ospino.2@bc.edu)

Inching Toward Solidarity: Intercultural Negotiations and Power Dynamics in Catholic Parishes Shared by Diverse Cultural Groups

Brett Hoover, Loyola Marymount University (Brett.Hoover@lmu.edu)

Bridging Diversity: Social Capital, Solidarity, and Prayer in Faith-Based Community Organizing

Richard Wood, University of New Mexico (rlwood@unm.edu)

Brad Fulton

Ruth Braunstein

Meeting the Needs of Latino Immigrants: Exploring Programs and Services Across Religious Traditions (Using the Chicago Latino Congregations Study)

Brian Starks, University of Notre Dame (brian.starks.2@nd.edu)

Jessica Hamar Martinez, Pew Forum on Religion & Public Life (jmartinez@pewresearch.org)

Edwin Hernandez, University of Notre Dame (edwinh@dvfoundations.org)

NOTES

Saturday, November 9, 3:45-5:15 PM

H-1. SSSR: *Sacred Stories, Spiritual Tribes: Finding Religion in Everyday Life*, by Nancy T. Ammerman (Oxford University Press, 2013).

Room: Revere

Organizer: Meredith McGuire, Trinity University (mmcguire@trinity.edu)

Convener: Jim Spickard, University of Redlands (jim_spickard@redlands.edu)

Discussant: Nancy Ammerman, Boston University (nta@bu.edu)

Critic: Wendy Cadge, Brandeis University (wcadge@brandeis.edu)

Critic: R. Stephen Warner, University of Illinois at Chicago (rswarner@uic.edu)

Critic: Susan Crawford Sullivan, College of the Holy Cross (ssullivan@holycross.edu)

H-2. SSSR: Biological and Evolutionary Aspects of Religion (BEAR) III

Room: Faneuil

Organizer: Jay Feierman, University of New Mexico (jay.feierman84@gmail.com)

Convener: John Teehan, Hofstra University (john.p.teehan@hofstra.edu)

Deception as a Biological Phenomenon and Its Role in Religion

Magnus Magnusson, Human Behavior Laboratory (msm@hi.is)

Of Gods and Devils: Differential Cognition and the Perception of Control

Thomas Ellis, Appalachian State University (ellistb@appstate.edu)

Accounting for Naturalistic Explanations of Religion: Theories and Evidence

Lluís Oviedo, Antonianum University (loviedo@antonianum.eu)

Socioecological Context and the Evolution of Gods' Minds

Benjamin Purzycki, University of British Columbia (bgpurzycki@alumni.ubc.ca)

H-3. RRA: Listen to Their Hearts: Religious Communities and the Use of Social Media - A Panel Discussion

Room: Douglass

Organizer: Perry Chang, Jefferson Community and Technical College (perrydchang@gmail.com)

Convener: Ida J. Smith-Williams, Research Services, Presbyterian Church (U.S.A.) (ida.smith-williams@pcusa.org)

How have religious communities been using social media and the web, and what issues has this raised? What lies in the future for religious community communication? Boston area religious leaders involved in social media use will discuss these issues with reference to religious communities with which they have worked and communities of which they are part. There will be plenty of time for audience questions, comments, and participation. Tweeting will be encouraged: #RRA13

H-3, cont.

Panelist: Rev. Laura E. Everett, Executive Director, Massachusetts Council of Churches (laura@masscouncilofchurches.org)

Panelist: Domenico Bettinelli, Creative Director, Pilot New Media, and Producer/Engineer, The Good Catholic Life radio program, Pilot Media Group, Roman Catholic Archdiocese of Boston (dbett@pilotnewmedia.com)

Panelist: Julie Unger, Coordinator, Engaging Families with Young Children in Jewish Life, Temple Israel of Boston, and Marketing Coordinator, Reform Jewish Outreach Boston (junger@tisrael.org)

H-4. SSSR: Religion and Science II

Room: Griffin

Convener: Sam Reimer, Crandall University (Sam.Reimer@crandallu.ca)

Action and Reaction: "Anti-Evolution" Curriculum Legislation and Mobilization of Conservative Protestants and the Scientific Community

David Johnson, Rice University (drj4@rice.edu)

Chris Scheitle, College of Saint Benedict

Elaine Howard Ecklund, Rice University

A Universe with No Religion?—Theological and Philosophical Implications of the Multiverse Theory

Witold Wolny, UVA - Wise (witold62@hotmail.com)

Science Defines Religion: How U.S. Scholars Define and Perceive Fundamentalism, Evangelical and Mainline Protestants

George Yancey, University of North Texas (george.yancey@unt.edu)

Sam Reimer, Crandall University

Jake O'Connell

Religion and "Eugenic" Sterilizations in the United States in the Twentieth Century: A Comparative Analysis

Lutz Kaelber, University of Vermont (lkaelber@uvm.edu)

H-5. SSSR: Different Careers Studying Religion: A Mentorship Panel for Graduate Students

Room: Adams

Organizer/Convener: Andrew Schaefer, University of New Hampshire (apq62@wildcats.unh.edu)

Panelist: Conrad Hackett, Pew Research Center (conradhackett@gmail.com)

Panelist: Penny Edgell, Professor of Sociology at the University of Minnesota (edgell@umn.edu)

Panelist: Roger Finke, Professor of Sociology and Religious Studies at The Pennsylvania State University and Director of the Association of Religion Data Archives (rfinke@psu.edu)

Panelist: Cynthia Woolever, Presbyterian Research (U.S.A.) (cynthia@cynthiawoolever.com)

Saturday, November 9, 3:45-5:15 PM

H-6. SSSR: Youth, Generations, and Religious Change (or Continuity)

Room: Otis

Organizer/Convener: Vern Bengtson, University of Southern California (Bengtson@usc.edu)

Discussant: Rhys Williams, Loyola University, Chicago (rwilliams7@luc.edu)

Catholic Millennials: Diversity and Commonalities by Gender and Ethnicity

Michele Dillon, University of New Hampshire (Michele.dillon@unh.edu)

Pentecostal Millennials: Spiritual Pilgrimage to the Dream Center

Richard Flory, University of Southern California (rflory@usc.edu)

Millennials and Their Families: Continuity and Contrast in Religious Expression

Vern Bengtson, University of Southern California (Bengtson@usc.edu)

Neal Krause, University of Michigan

R. David Hayward, University of Michigan

H-7. SSSR/MSSA: A House Full of Females: Faith and Family in Nineteenth-Century Mormon Diaries (MSSA Glenn M. Vernon Lecture)

Room: Webster

Organizer/Convener/Discussant: Henri Gooren, Oakland University (gooren@oakland.edu)

A House Full of Females: Faith and Family in Nineteenth-Century Mormon Diaries

Laurel Thatcher Ulrich, Harvard University (ulrich@fas.harvard.edu)

H-8. SSSR: Pentecostalism, Politics, and Political Culture: A Comparative Perspective

Room: Burroughs

Organizer/Convener: Daniel Jordan Smith, Brown University (daniel_j_smith@brown.edu)

Discussant: Paul Freston, Wilfrid Laurier University (pfreston@gmail.com)

The Indirect Political Impact of Pentecostalism in Contemporary India: Evangelism, Healing, and the Conversion Controversy

Chad Bauman, Butler University (cbauman@butler.edu)

Patriotic Pentecostals

Karrie Koesel, University of Oregon (koesel@uoregon.edu)

Pentecostalism, Prosperity, and Corruption in Nigeria: Political Revolution or Ponzi Scheme?

Daniel Jordan Smith, Brown University (daniel_j_smith@brown.edu)

Pentecostalized Religion and Political Culture in Central America

Richard Wood, University of New Mexico (rlwood@unm.edu)

H-9. SSSR: Mediating Religion: Political Institutions and the Policy Process

Room: Carlton

Organizer: Kevin den Dulk, Calvin College (krd33@calvin.edu)

Convener: Elizabeth Oldmixon, University of North Texas (oldmixon@unt.edu)

The Scope and Limits of Religious Legal Advocacy

Daniel Bennett, Southern Illinois University (bennettd@siu.edu)

Religion Interest Groups: Do They Sing with an Upper Class Accent?

Tobin Grant, Southern Illinois University (grant@siu.edu)

Sandy Kim, Southern Illinois

Robert Velez, Southern Illinois

Religion, the Presidency, and the Executive Branch

Mark Rozell, George Washington University (mrozell@gwu.edu)

Religion and Judicial Decision-Making

Kevin den Dulk, Calvin College (krd33@calvin.edu)

H-10. SSSR: Islam in the West

Room: Hancock

Convener: Jonas Hart, University of Virginia (jonas.hart@virginia.edu)

Explaining the Muslim Employment Gap: Individual Differences Between Muslims and Non-Muslims in Western Europe

Phillip Connor, Pew Research Center (pconnor@pewresearch.org)

Matthias Koenig, Goettingen University (matthias.koenig@sowi.uni-goettingen.de)

Islam in France and Switzerland crises to appear in public space

Christophe Monnot, University of Lausanne (christophe.monnot@unil.ch)

Misunderstood Population? Muslims in the West

Yaghooob Foroutan, Mazandaran University/Waikato University (y_foroutan@yahoo.com)

Islamic Coherence?: Locating Religious Variation Among American Muslims

John O'Brien, NYU Abu Dhabi (jho3@nyu.edu)

H-11. SSSR: Refining Methods for Studying Religion

Room: Paine

Convener: Philip Brenner, University of Massachusetts Boston (philip.brenner@umb.edu)

Relationships with God Among Young Adults

Nicolette Manglos, Williams College (nmanglos@gmail.com)

Margarita Mooney, Yale University (margarita.mooney@yale.edu)

Ken Bollen, University of North Carolina-Chapel Hill

Micah Roos, University of North Carolina-Chapel Hill

What's in a Name? The Effect of Question Wording and Order on Religious Identification

Besheer Mohamed, Pew Research Center (bmoham773@gmail.com)

Saturday, November 9, 3:45-5:15 PM

H-11, cont.

Toward a Multilevel Explanation of a "Personal Relationship with Jesus": From Big Histories to Little Conversations
Benjamin Bennett-Carpenter, Oakland University (bennettc@oakland.edu)

H-12. SSSR: Social Psychological Approaches Room: Bulfinch

Convener: Michael J. Balboni, Harvard Medical School (Michael_Balboni@dfci.harvard.edu)

Understanding Object Representations of Mother, Father, and God Among Individuals with Psychosis
Tracy Prout, College of Mount Saint Vincent (TracyProut@gmail.com)

Does the Extended Contact Effect Apply to Religion? An Experimental Design Examining Muslims and Mosques in the United States
Alfredo Garcia, Princeton University (alfredog@princeton.edu)
Matthew Trujillo, Princeton University

A Textual Analysis of the Social Psychological Structure of the Torah
Tara Kahn, Wesleyan University (tkahn57@gmail.com)

Latin Meets Greek: Loves in Counterpoise.

Christopher Rupert, Independent Researcher, Society of Jesus (crupert@jesuits.ca)

H-13. SSSR: FILM: Enlarging the Kingdom: African Pentecostals in Italy Room: Lewis

Organizer/Convener: Annalisa Buttici, Harvard University/Utrecht University (abutticci@hds.harvard.edu)

Discussant: Nimi Wariboko, Newton Theological School (nwariboko@ants.edu)

Discussant: Franco Sacchi, Independent Filmmaker (needed@maryvillecollege.edu)

Discussant: S. Brent Plate, Hamilton College (splate@hamilton.edu)

H-14. SSSR: Interfaith Dialogue Room: Alcott

Convener: Eileen Barker, London School of Economics (e.barker@lse.ac.uk)

American Evangelicals on Islam: The Construction of a Dominant Discourse
Roger Baumann, Yale University (roger.baumann@yale.edu)

Power and the Interfaith Encounter

Maria Van Ryn, Yeshiva University (riavanryn@gmail.com)

Outreach and Exclusivity: Interreligious Dialogue, Ingroup Boundaries and Outgroup Contact
Peter Ryan, Notre Dame (pryan15@nd.edu)

H-14, cont.

The Politics and Theology of Interfaith Dialogue in the Muslim World
Turan Kayaoglu, University of Washington (turan@uw.edu)

H-15. SSSR/RRA: Emerging Adults Room: Hale

Convener: Ariela Keysar, Trinity College (akeysar@aol.com)

Chasing the American Dream: Religion, Social Class, and the Aspirations of Emerging Adults
Hilary Davidson, Notre Dame (hdauidso@nd.edu)

Twenty-Somethings and Congregations: Preliminary Results from a National Survey
Tim Clydesdale, The College of New Jersey (clydesda@tcnj.edu)

Parents and Friends: Exploring Change of Religiosity from Adolescence to Early Adulthood in the U.S.
Fanhao Nie, Purdue University (nief@purdue.edu)
Daniel Olson, Purdue University

5:30-6:15 PM SSSR Presidential Address
Michele Dillon, "Asynchrony in Attitudes toward Abortion and Gay Rights: The Challenge to Values Alignment"
Harbor 2/3

6:15-7:00 PM SSSR Reception
Harbor Foyer

7:00 -7:30 PM: Honoring the Life and Work of Andrew Greeley
Lewis

Convener: Wade Clark Roof, University of California Santa Barbara

7:30 -8:00 PM: Honoring the Life and Work of Robert Bellah
Burroughs

Convener: Richard Wood, University of New Mexico

8:00 PM Grad Student Meet-Up in Lobby to Go Out

SUNDAY

**7:00 -8:00 AM Breakfast for Scholars
of Islam (All are welcome. FREE for
graduate students, \$10 for all others)
Harbor 1**

**7:00 -7:45 AM RRX Breakfast
Harbor 2**

Sunday, November 10, 8:00-9:30 AM

I-1. RRA: Assessing Religious Communities and Their Projects and Programs Room: Bulfinch

Convener: Joelle Kopacz, Research Services, Presbyterian Church (U.S.A.) (joelle.kopacz@pcusa.org)

The Power of Religion in Raising HIV/AIDS Awareness: Creative Methods of HIV/AIDS Education in Malawi

Deborah Coe, Presbyterian Research Services (deborah.coe@pcusa.org)

Conflict, Culture and Communication: The Challenge of Evaluating an International Youth Leadership Program

Sharon L. Miller, Auburn Theological Seminary (SMiller@auburn-seminary.org)

Moving Together: New Canadian Church Planters and Canadian Denominational Leaders

Mark Chapman, Tyndale Seminary (mchapman@tyndale.ca)
James Watson, Salvation Army

Measuring Congregational Vitality: Phase 3 – Initial Implementation and Implications for Denominations

Linda Bobbitt, ELCA (lbobbitt2.0@gmail.com)

I-2. SSSR: Immigration and Social Support Room: Faneuil

Convener: Tricia Bruce, Maryville College (tricia.bruce@maryville-college.edu)

The Role of Religion and Social Support in the Use of Mental Health Services Among Immigrants in the United States

Amelia Derr, Seattle University (seraphia@u.washington.edu)

Dynamics of Social Relationships in a Korean Immigrant Church: From Youths' Perspective

Jichan Kim, University of Wisconsin - Madison (jichan.kim@gmail.com)

Religion and Immigration Attitudes: Examining the Influence of Values
Stephen Merino, The University of Texas-Pan American (merin-osm@utpa.edu)

Religion, Gender, and Assimilation: West African Teenagers
Bethany Weed, University of Pennsylvania (bweed@sas.upenn.edu)

I-3. SSSR: Modes of Teaching: Psychological Approaches to Understanding Religion Room: Griffin

Organizer: Kevin Ladd, Indiana University South Bend (kladd@iusb.edu)

Teaching Experimental Psychology for the Study of Religion
Kevin Ladd, Indiana University South Bend (kladd@iusb.edu)

Teaching an Interdisciplinary Course in Psychology AND Religion
Elizabeth Weiss Ozorak, Allegheny College (eozorak@allegheny.edu)

Managing a Discussion-Oriented Psychology of Religion Class
Jo-Ann Tsang, Baylor University (JoAnn_Tsang@Baylor.edu)

Blending Research and Application in a Psychology of Religion Survey Course

Michael Nielsen, Georgia Southern University (mnielsen@georgia-southern.edu)

I-4. SSSR: Religion and Social Movements Room: Adams

Convener: Justin Van Ness, University of Notre Dame (jvanness@nd.edu)

The Transnational Nature of Religious Environmental Activism
Laurel Kearns, Drew University (lkearns@drew.edu)

Religious Movements, State, Civil Society and the Arab Spring
Zubeyir Nisanci, Loyola University Chicago (znisanci@luc.edu)

Social Movements as an Agent of Change in a Post-Secular Context: A Case Study of Religious LGBT Activism in Finland

Peter Nynäs, Åbo Akademi University (peter.nynas@abo.fi)

Mika Lassander, Åbo Akademi University

"The Cause of the Fatherless": An Organizational Analysis of the Rising Evangelical Adoption and Orphan Care Movement

Samuel Perry, University of Chicago (samperry@uchicago.edu)

Sunday, November 10, 8:00-9:30 AM

I-5. RRA: The Study of Islam and Muslims in the Post-9/11 Era: A British Experience

Room: Alcott

Organizer/Convener/Discussant: Hossein Godazgar, Al-Maktoum College of Higher Education (h.godazgar@almcollege.org.uk)

Collaborative Partnerships Between Universities and Muslim Institutions: Dismantling the Roadblocks

Sariya Cheruvallil-Contractor, University of Derby (s.contractor@derby.ac.uk)

Alison Scott-Baumann, University of Derby (A.Scott-Baumann@derby.ac.uk)

Teaching Women in Islam

Masoumeh Velayati, Al-Maktoum College of Higher Education (m.velayati@almcollege.org.uk)

A Good Practice for Academic Collaborations: Al-Maktoum College of Higher Education

Hossein Godazgar, Al-Maktoum College of Higher Education (h.godazgar@almcollege.org.uk)

I-6. SSSR: Trust and Authenticity

Room: Otis

Convener: Christine Soriea Sheikh, University of Denver (Christine.Sheikh@du.edu)

Authenticity and the "Ethics of Compassion" Among Christian Evangelicals

Francesca Montemaggi, Cardiff University (montemaggife@cardiff.ac.uk)

Image of God, Embeddedness, and Social Trust

Brittany Fitz, Baylor University (Brittany_Fitz@baylor.edu)

Matt Henderson, Baylor University

Carson Mencken, Baylor University

Religious Diversity, Religious Participation, and Generalized Trust

Miao Li, Purdue University (dolson@purdue.edu)

Daniel Olson, Purdue University (dolson@purdue.edu)

The Song of Serotonin and the Dance of Dopamine: How Religions Capture the Neurobiology of Trust and Group Cohesion

J. Anderson Thomson, Jr., University of Virginia (ja4m@eservices.virginia.edu)

I-7. SSSR: Preaching Research I

Room: Webster

Organizer/Convener: Pierre Hegy, Adelphi University (pierre.hegy@gmail.com)

Social Structure in the Sermons of the Beachy Amish-Mennonites, Plain Mennonites, and Charity Churches

Cory Anderson, Ohio State University (dranderson@beachyam.org)

I-7, cont

Talking about Divorce from the Pulpit

Don A. Wicks, School of Library & Information Science, Kent State University (dwicks@kent.edu)

Daniel R. Roland, School of Library & Information Science, Kent State University

Handling Differences in the Sermon: Bell, Keller, and Pfleger

Rochelle Cathcart, Lincoln Christian University (rlcathcart@lincolnchristian.edu)

NVivo and the Analysis of Sermons in a Seminary Context

Robert Priest, Trinity Evangelical Divinity School (rpriest@tiu.edu)

I-8. SSSR: Religion in the Workplace

Room: Burroughs

Convener: Meg Wilkes Karraker, University of St. Thomas (mwkarraker@stthomas.edu)

The Ambivalence of Religion in the Neoliberal Workplace: Catholicism and Mercenary Professionalism in Dubai and Bangalore

Brandon Vaidyanathan, Rice University (brvnathan@gmail.com)

The Evolution of the Missions of Seventh-day Adventist Hospitals

Ronald Lawson, Queens College, CUNY (ronaldlawson@nyc.rr.com)

Religious Family Values, Family Business Virtues: A Study of Two Generations in 15 Family Firms

Meg Wilkes Karraker, University of St. Thomas (mwkarraker@stthomas.edu)

Ritch Sorenson, University of St. Thomas

Gendered Labor Patterns in U.S. Counties: Assessing the Role of Religious Affiliation

Andrew Schaefer, University of New Hampshire (apq62@wildcats.unh.edu)

I-9. SSSR: The Politics of Abortion

Room: Carlton

Convener: Rebecca Sager, Loyola Marymount University (resager@gmail.com)

Mainline Protestants and the Politics of Abortion after Roe v. Wade

Sabrina Daniels, University of Pennsylvania (dsabrina@sas.upenn.edu)

Religion and Public Attitudes toward Abortion Among Turkish Adults: From Islamic Perspective

Dogan Hatun, University of Texas at San Antonio (doganhatur@gmail.com)

Murat Yilmaz, University of Texas at San Antonio

A Right in Name Only? State Variation in the Accessibility of Abortion Services and the Passage of Abortion Restrictions in 2011

Rebecca Sager, Loyola Marymount University (resager@gmail.com)

Keith Bentele, University of Massachusetts Boston

Sunday, November 10, 8:00-9:30 AM

I-10. SSSR/RRA: Childhood and Youth **Room: Lewis**

Convener: Kati Li, Princeton University (kathrynl@princeton.edu)

How Religion Affects Children's Preference Between Themes of Forgiveness and Retribution in Children's Literature

Victoria McCoy, University of North Alabama (vmclain@una.edu)

Ryan Zayac, University of North Alabama

Gabriela Carrasco, University of North Alabama

The Discursive Frameworks of Being Young and Muslim in London
Titus Hjelm, University College London (t.hjelm@ucl.ac.uk)

Religious Identity Development Among Muslim American Youth

Hasina Mohyuddin, Vanderbilt University (hasina.a.mohyuddin.1@vanderbilt.edu)

Patterns of Faith Community Among Urban Young People

Philip Hughes, Christian Research Association (p.hughes@cra.org.au)

I-11. SSSR: Criminology and Deviance **Room: Hancock**

Convener: William H. Swatos, Baylor University (William_Swatos@baylor.edu)

Finding Faith in Faith-Based Prisons

Brad Stoddard, Florida State University (bs10g@my.fsu.edu)

Religiosity, Attitude Towards Corruption and Cheating Among Muslim Students at Islamic Higher Education in Indonesia

Ibnu Hadjar, IAIN Semarang Indonesia (ibnuhadjar2010@yahoo.co.id)

Religion, Deviance, and Well-Being Among American University Students—Final Data Report

Jerome Koch, Texas Tech University (jerome.koch@ttu.edu)

Alden Roberts, Texas Tech University

Myrna Armstrong, Texas Tech University Health Sciences Center

I-12. SSSR: Economics of Religion **Room: Paine**

Convener: Jörg Stolz, University of Lausanne (joerg.stolz@unil.ch)

Urban Christian Churches as Resource Brokers

Kirk Foster, University of South Carolina (kfoster@mailbox.sc.edu)

Consumption as a Source of Religious Change. Economic Growth, Affluent Consumption, and the Crowding Out of Traditional Religion

Jochen Hirschle, Universitaet Innsbruck (jochen.hirschle@uibk.ac.at)

"Idleness is an Enemy of the Soul" - Monastics and Economic Development

Garrett Smith, Kennesaw State University (gsmith@kennesaw.edu)

How Does Religion Contribute to Australia's Neoliberal Project?

Marion Maddox, Macquarie University (marion.maddox@mq.edu.au)

I-13. SSSR: Congregational Leadership **Room: Harbor 3**

Convener: Nathaniel Porter, The Pennsylvania State University (ndp135@psu.edu)

System Dynamics as a Tool for Investigating Church and Religious Growth

John Hayward, University of South Wales (john.hayward@south-wales.ac.uk)

Leadership Development Experiences of Exemplary Roman Catholic Parish Priests: An Exploratory Study

Rosemarie Ong, George Washington University (rmaong@gwu.edu)

"God Built This": Religion Entrepreneurship, Church-Founding, and Risk Perception

Richard Pitt, Vanderbilt University (r.pitt@vanderbilt.edu)

Homeward Bound: Pastors and Their Closing Churches

Gail Cafferata, Boston University (revgailc@gmail.com)

I-14. SSSR: Asian American Christian Communities: Diversity and Transformation **Room: Douglass**

Organizer/Convener: Thien-Huong Ninh, Williams College (ttn1@williams.edu)

Discussant: R. Stephen Warner, University of Illinois at Chicago (rswarner@uic.edu)

Religion and Filipino American Community Formation

Stephen M. Cherry, University of Houston Clear Lake (cherry@uhcl.edu)

Yellow by Choice: Vietnamese Catholics and Race

Linh Hoang, Siena College (lhoang@siena.edu)

Re-Visualizing Our Blessed Mother in the Diaspora: Marianism Among Vietnamese Catholics in the U.S. and Cambodia

Thien-Huong Ninh, Williams College (ttn1@williams.edu)

Ethnic Insularity Among 1.5 and Second Generation Korean American Christians

Jerry Park, Baylor University (Jerry_park@baylor.edu)

Sunday, November 10, 8:00-9:30 AM

I-15. SSSR: Adaptation in Religion Traditions Room: Revere

NOTES

Convener: Eileen Barker, London School of Economics (e.barker@lse.ac.uk)

Spaces Between: Tensions in the Lives of Latter-Day Saints
Amy Moff Hudec, Boston University (moff@bu.edu)

Understanding Political Diversity Among American Mormons
Laura Olson, Clemson University (laurao@clemson.edu)
Marie Cornwall, Brigham Young University

Interviewing Buddhist Clergy in Fukushima, Japan: Buddhist Clergy's Disaster Relief Efforts from Fukushima Nuclear Power Plant Accident.
Tatsushi Hirono, Austin Peay State University (hironot@apsu.edu)

From Buddhist-Inspired Meditation to Mindfulness as a Secular Panacea: How Meditation Moves
Jaime Kucinkas, Indiana University (jlkucins@indiana.edu)

I-16. SSSR: Comparative Perspectives on Religion and State Room: Hale

Convener: Katherine Meyer, Ohio State University (meyer.23@osu.edu)

Religion at Work as Political Assumption: (Anti)Secularist Discourse in Egyptian Politics
Martin Rowe, Boston University (martin.t.rowe@gmail.com)

Political Confucianism Under Korean Authoritarian Governments
Ha Jung Lee, Boston University (hajung.lee@gmail.com)

Religious Repression in Authoritarian Regimes: Why Does It Vary?
Ani Sarkissian, Michigan State University (asarkiss@msu.edu)

A More Friendly Separation: German Secularism and the Work of Ernst-Wolfgang Boeckenfoerde as a Heuristic Key for Contemporary Debates on Democratic Religion-State Relations
Mirjam Kuenkler, Princeton University (kuenkler@princeton.edu)
Tine Stein, University of Kiel

Sunday, November 10, 9:45-11:15 AM

J-1. SSSR: New Research in Spirituality

Room: Bulfinch

Convener: Thomas Kersen, Jackson State University (thomas.m.kersen@jsums.edu)

Metaphors of Mysticism/Spirituality in Popular Hiking Literature
Thomas Kersen, Jackson State University (thomas.m.kersen@jsums.edu)

Larry Bates, University of North Alabama
Richard Hudiburg, University of North Alabama

The Effects of Spirituality on the Investment to Human Capital in Pakistan Economy

Imran Haq Nawaz, Pakistan Institute of Development Economics (ihnawaz@yahoo.com)

An Online ESM Study of Daily Spirituality

Brad Wright, University of Connecticut (bradley.wright@uconn.edu)

Issues of Authenticity in Contemporary Spiritualities

Deirdre Meintel, Université de Montréal (dmeintel@videotron.ca)

J-2. RRA: Catholic Potpourri

Room: Hale

Organizer/Convener: Mary Gautier, Center for Applied Research in the Apostolate (CARA) at Georgetown University (gautierm@georgetown.edu)

A Case for "Moral Priming": Randomizing Question Placement and Response Bias

Melissa Cidade, CARA at Georgetown University (mac288@georgetown.edu)

Carolyn Saunders, CARA at Georgetown University

The Geography of Catholic Cultural Diversity in the United States

Tom Gaunt, SJ, CARA at Georgetown University (tpg9@georgetown.edu)
Eva Coll, CARA at Georgetown University

Vatican II and the Decline in Catholic Commitment: A Review of the Academic Literature

Paul Perl, CARA at Georgetown University (pmp2@georgetown.edu)

J-3. SSSR: Cognitive Approaches to Religion

Room: Faneuil

Convener: Alison Scott-Baumann, University of Derby (A.Scott-Baumann@derby.ac.uk)

Cognitive Perspectives on Religious Aesthetics

Steven Hrotic, University of Vermont (steven.hrotic@uvm.edu)

The Intrusion of Intuitive Concepts in an Offline Processing Task: The Theological Correctness Effect

Laird Edman, Northwestern College (ledman@nwciova.edu)
Kirsten McConnel, Northwestern College

J-3, cont.

Self-Interest, Ultimate Meaning, and the Full Realization of Symbolic Consciousness

Jonathan Doner, Private (jfd@donersystems.com)

A Critical Look at Meaning-Making as a Religious Motivation

Nurit Novis Deutsch, Haifa University (nurit.novis@gmail.com)

J-4. RRA: Navigating the Labor Market in Sacred Places: How Latino Congregations Support the Labor Aspirations of Latin@s—A Panel Discussion

Room: Douglass

Organizer/Convener: Edwin Hernandez, University of Notre Dame (edwinh@dvfoundations.org)

Discussant: Ram Cnaan, University of Pennsylvania (cnaan@ssw.upenn.edu)

This panel will discuss how religion works to support the labor market needs in the Latino community. Using the findings from the Chicago Latino Congregations Study as a framework, the panel conversation will focus on the role that congregations play in labor market needs among urban populations.

Panelist: Rebecca Burwell, Trinity University (rebeccab@chicagosemester.org)

Panelist: Jessica Hamar Martinez, Pew Forum on Religion and Public Life

(jmartinez@pewresearch.org)

Panelist: Milagros Pena, University of Florida (mpena@soc.ufl.edu)

Panelist: Ariana Salazar-Newton, University of Notre Dame (joshandariana@gmail.com)

J-5. SSSR: Religion and Mental Health

Room: Adams

Convener: Christine Soriea Sheikh, University of Denver (Christine.Sheikh@du.edu)

Americans' Beliefs about the Treatment of Mental Illness: Does Religion Matter?

Christopher Ellison, University of Texas, San Antonio (christopher.ellison@utsa.edu)

Xiaohe Xu, University of Texas, San Antonio

The Religion-Health Connection Between Mental Health and Chronic Disease Among Latino Immigrants

Ephraim Shapiro, Smokler Center for Health Policy Research, Myers-JDC-Brookdale Institute (eas97@caa.columbia.edu)

How Actors Navigate Diversity in Contemporary Times: Evangelical Mental Health Therapists and Their Interactions with Clients

Kati Li, Princeton University (kathrynli@princeton.edu)

Sunday, November 10, 9:45-11:15 AM

J-6. SSSR: Building a Scholarly Life and Maintaining Work-Life Balance: Challenges and Strategies

Room: Alcott

Organizer/Convener: Michele Dillon, University of New Hampshire (michele.dillon@unh.edu)

Panelist: Korie Edwards, Ohio State University (kle@sociology.osu.edu)

Panelist: Michael Nielsen, Georgia Southern University (mn-nielsen@georgiasouthern.edu)

Panelist: Susan Crawford Sullivan, College of the Holy Cross (ssul-liva@holycross.edu)

J-7. SSSR: Preaching Research II

Room: Webster

Organizer: Pierre Hegy, Adelphi University (pierre.hegy@gmail.com)

Convener: Robert Priest, Trinity Evangelical Divinity School (rpriest@tiu.edu)

Narrative Sermon Effects: An Experimental Survey in the US and Japan

Mitsuharu Watanabe, Kanto-Gakuin University (one@mailsignal.net)

Akira Kawabata, Oosaka University

Homeward Bound: Last Sermons of Pastors at Their Closing Churches

Gail Cafferata, Center for Practical Theology, Boston University School of Theology (revgailc@gmail.com)

Superstar Preachers: Joel Osteen and Joyce Meyer in Comparative Perspective.

Pierre Hegy, Adelphi University (pierre.hegy@gmail.com)

Catholicism's Radical Call to Preach Homilies and Not Sermons

Richard Ling, Catholic Church (homilies@comcast.net)

J-8. SSSR: Religion in Turkey

Room: Otis

Convener: Mentor Mustafa, Boston University (mentor@bu.edu)

Power Struggle Between Pious Muslims? (Dis)agreement Between and Within the Turkish State and Society

Berna Turam, Northeastern University (b.turam@neu.edu)

A Comparative Analysis of Creationism in Turkey and the United States

Jeffrey Guhin, Yale University (jeffrey.guhin@yale.edu)

Gulay Turkmen, Yale University

The Contradictions of a Strict Secularization Project as Social Engineering in Turkey

Serhan Tanriverdi, Loyola University Chicago (stanriverdi@luc.edu)

Religion and Fertility in Turkey

Murat Yilmaz, University of Texas, San Antonio (muratist@mynet.com)

Dogan Hatun, University of Texas at San Antonio

J-9. SSSR: Denominational Growth and Change

Room: Burroughs

Convener: Maria Van Ryn, Yeshiva University (riavanryn@gmail.com)

Pentecostals in Algeria: The Context of Emergence and the Impact on the Environment

Mustapha Radji, University of Mostaganem-CRASC-Oran (musradji@yahoo.co.uk)

Abdelkader Abdelaali, University of Saida-Crasc-Oran

Belkacem Manseur, Faculty of Law and Police Science-University of Oran

The Emerging Church Movement: A Quantitative Portrait

Gerardo Marti, Davidson College (gemarti@davidson.edu)

Paul J. Olson, Briar Cliff University

The Structure of the Evangelical Field

Brad Vermurlen, University of Notre Dame (bvermurl@nd.edu)

Comparing and Contrasting the Growth Rates of Mormons, Adventists and Witnesses in Mexico

Ronald Lawson, Queens College, CUNY (ronaldlawson@nyc.rr.com)

J-10. SSSR: Poverty, Development, and Religion

Room: Carlton

Organizer: Stephen Offutt, Asbury Seminary (soffutt_1999@yahoo.com)

Convener: Margarita Mooney, Yale University (margarita.mooney@yale.edu)

Altruism and Development: An Uneasy Alliance of Theory and Praxis

LiErin Probasco, Princeton University (probasco@princeton.edu)

Measurements of Religious Composition and Poverty in Mexico from Census Data: Exploratory Analysis

Juan Carlos Esparza Ochoa, Pew Forum (JEsparzaOchoa@pew-forum.org)

Robert Woodberry, National University of Singapore

Religion, Development, and Modernization

Stephen Offutt, Asbury Seminary (soffutt_1999@yahoo.com)

J-11. SSSR: Atheist Worldviews and Communities

Room: Lewis

Convener: Nathaniel Porter, The Pennsylvania State University (ndp135@psu.edu)

Atheism and Well-Being: An Application of the Rejection-Identification Model

Michael Doane, University of Nevada Reno (mdoane@unr.edu)

Marta Elliott, University of Nevada Reno (melliott@unr.edu)

The Humanist Community Project: Building Organized Humanist Communities in the United States

Marcus Mann, Duke University (marcus.mann@duke.edu)

Sunday, November 10, 9:45-11:15 AM

J-11, cont.

The Social Meaning of Atheism: Interaction, and the Construction of Worldview

Jesse Smith, Western Michigan University (jesse.m.smith.soc@gmail.com)

How Do You Find Good Without God?: An Atheist Morality

George Yancey, University of North Texas (george.yancey@unt.edu)
David Williamson, University of North Texas

J-12. SSSR: Congregational Life and Vitality

Room: Hancock

Convener: Kristina Lizardy-Hajbi, United Church of Christ (hajbik@ucc.org)

Congregational Vitality: Lay vs. Clergy perspectives and Connection to Clergy Satisfaction

Linda Bobbitt, ELCA (lbobbitt2.0@gmail.com)

Characteristics of Congregations That Might Increase Their Participants' Risk of Depression

Hui-Tzu Grace Chou, Utah Valley University (chougr@uvu.edu)
Jeremy Hofer, Utah Valley University

Salience and Congregational Growth: Revisiting the Strictness Thesis
Todd Ferguson, Baylor University (todd_ferguson@baylor.edu)

J-13. SSSR: Gender Equality

Room: Paine

Convener: Christopher L. Chiappari, St. Olaf College (chiappar@stolaf.edu)

Religiosity and Fundamentalism as Factors of Perception about Gender Equality Among Indonesian Muslim Students

Umul Baroroh, IAIN Semarang, Indonesia (umul.baroroh@yahoo.co.id)

"The Institutional Church for Me is Dying": Perceptions of Gender and Public Life in Women's Transnational Religious Organizations

Casey Clevenger, Brandeis University (casey.clevenger@gmail.com)

Religion and Religious Doubt: Assessing Gender Equality vs. Domination Among the Indigenous in the Western Highlands of Guatemala
Paul Kasun, University of Texas at Austin (FrPaul@utexas.edu)

The Influence of Masculinity, Islam, and Insecurity on Gender Attitudes in the Middle East and North Africa

Jaime Kucinkas, Indiana University (jlkucins@indiana.edu)
Tamara van der Does, Indiana University

J-14. SSSR/RRA: Megachurches and Bible Knowledge

Room: Revere

Convener: Adair T. Lummis, H. Institute for Rel. Research (alummis@hartsem.edu)

Waiting for the Four Blood Moons: Apocalyptic narratives in a Texas megachurch after the election of 2012

Fredrik Gregorius, Pennsylvania State University (jug27@psu.edu)

Large Church Senior Pastor Succession—Statistics and Models

Warren Bird, Leadership Network (warren.bird@leadnet.org)

"He's on Fire": Charismatic Leadership in American Megachurches
Katie Corcoran, Baylor University (katie_corcoran@baylor.edu)

James K. Wellman, University of Washington

How Will I Know? Bible Content Knowledge Among Those Affiliated with the Presbyterian Church (U.S.A.)

Perry Chang, Jefferson Community and Technical College (perrydchang@gmail.com)

J-15. SSSR: NGOs/Non-Profit Organizations

Room: Griffin

Convener: Meredith Whitnah, University of Notre Dame (mwhitnah@nd.edu)

Re-imagining Charity in America: The Case of American Muslims—Role of Local vs. Global Giving in Impacting Notions of "Community"

Sabithulla Khan, Virginia Tech (khanpgg@vt.edu)

Reclaiming the Battlefield: The Religious Origins of International Humanitarian Law

Shai Dromi, Yale University (shai.dromi@yale.edu)

From Race to Gender: Faith-Based Organizations and the "New" South Africa

Meredith Whitnah, University of Notre Dame (mwhitnah@nd.edu)

The Influence of Islam on Transnational Humanitarian Aid: Aid Campaigns of Turkish NGOs in East Africa

Koray Özdil (koray.ozdil@tese.org.tr)

Period A: pp 4-7

Period B: pp 8-10

Period C: pp 11-13

Period D: pp 14-17

Period E: pp 18-21

Period F: pp 22-25

Period G: pp 26-29

Period H: pp 30-32

Period I: pp 33-36

Period J: pp 37-39

A

Abdelaali, Abdelkader J-9
 Abel, Andrew Stuart B-8
 Abelow, Benjamin F-3
 Abraham, Paul E-9
 Abulof, Uriel C-14
 Acevedo, Gabriel A. B-8, C-14, D-15, F-13
 Adler, Gary B-12
 Adogame, Afe C-2, D-17
 Ahmad, Muhammad Aurangzeb F-15
 Alshunyber, Khaled A-5
 Althouse, Peter D-16
 Ammar, Diala D-15
 Ammerman, Nancy E-5, H-1
 Amole, Victor C-4
 Andercheck, Brita D-2, E-12, F-17
 Anderson, Cory B-13, D-13, G-15, I-7
 Anderson, Shawna C-3, D-3
 ap Siôn, Tania B-2, F-4
 Araceli, Melissa D-10
 Armstrong, Myrna I-11
 Avishai, Orit E-17
 Aymer, Paula E-14

B

Bader, Christopher F-8
 Baer, Alejandro D-6
 Bahr, Matt G-6
 Baines, Charlotte F-13
 Baker, Joseph C-6, F-10
 Baker, Josiah R. F-1
 Bakker, Janel Kragt E-13
 Balboni, Michael J. A-2, H-12
 Banaji, Mahzarin R. A-9
 Barker, Eileen F-9, H-14, I-15
 Baroroh, Umul J-13
 Barry, David D-9
 Barth, Whitney B-7
 Bates, Larry J-1

INDEX

Bauman, Chad H-8
 Baumann, Roger H-14
 Beaman, Lori E-10, G-16
 Beckford, James A. E-10, F-9
 Beldi de Alcantara, Maria E-14
 Bell, David G-14
 Bellofatto, Gina B-10
 Bendroth, Margaret D-1
 Bengtson, Vern H-6
 Bennett, Daniel H-9
 Bennett-Carpenter, Benjamin A-7, H-11
 Bentele, Keith I-9
 Berger, Elliot G-15
 Berger, Helen D-11
 Bertolucci, Dominic H-3
 Bibby, Reginald F-10
 Bielo, James G-8
 Bird, Warren E-8, J-14
 Blancke, Stefaan D-16
 Bobbitt, Linda I-1, J-12
 Bollen, Ken H-11
 Bonacci, Kristin Geraty F-12
 Bonney, Norman C-14
 Borella, Andrea G-15
 Borella, Andy B-5
 Boudry, Maarten D-16
 Bouma, Gary A-6, B-13, D-15
 Bowman, Nicholas G-6
 Boyd, Katharine C-6
 Brady, Elizabeth F-7
 Brammli-Greenberg, Shuli D-8
 Braunstein, Ruth B-12, G-17
 Brenneman, Robert E-14, F-11, G-9
 Brenner, Philip E-16, H-11
 Briggs, David E-5
 Briskman, Linda F-7
 Bruce, Tricia A-15, F-5, I-2
 Brugman, Dylan F-2
 Burgess, Aaron A-5
 Burgoyne, Stephanie D-5
 Burwell, Rebecca J-4
 Buttici, Annalisa B-2, C-2, H-13

C

Cadge, Wendy A-2, G-13, H-1
 Cafferata, Gail D-8, I-13, J-7
 Caldwell-Harris, Catherine G-1
 Carlson, Neil E-11
 Carrasco, Gabriela I-10
 Carroll, Christopher F-5
 Cathcart, Rochelle I-7
 Chan, Esther E-9, G-7
 Chang, Perry D-1, H-3, J-14
 Chapman, Mark I-1
 Charlton, Joy A-2
 Chaves, Mark A-11, C-3, D-3, E-11
 Chen, Yun F-5
 Cheng, Zhen B-11
 Cherry, Stephen M. F-12, I-14
 Cheruvallil-Contractor, Sariya I-5
 Chestnut, Andrew D-10

Chiappari, Christopher L. A-14, D-10, E-1, G-9, J-13
 Chou, Hui-Tzu Grace J-12
 Christerson, Brad C-9
 Cidade, Melissa C-4, E-16, J-2
 Cieslak, Michael B-6, C-4, D-2, G-4
 Clark, April A-12, A-6
 Clendenen, Margaret G-13
 Clevenger, Casey J-13
 Clydesdale, Tim H-15
 Cnaan, Ram J-4
 Cobb, Ryon B-1, D-9, G-7
 Coe, Deborah A-1, I-1
 Coll, Eva J-2
 Connor, Phillip F-12, H-10
 Corcoran, Katie J-14
 Corner, Shanna A-12
 Cornwall, Marie I-15
 Cottee, Simon E-15
 Cousineau, Madeleine B-4
 Cox, Michael D-18
 Crabtree, Sarah C-12
 Cragun, Ryan T. D-16, E-1
 Cranney, Stephen D-13
 Crawford Sullivan, Susan H-1, J-6
 Crea, Giuseppe F-4
 Crubaugh, Bryant D-17
 Cuartas, Victor C-10

D

Cunningham, Maurice C-6
 D'Antonio, William V. A-15, F-1
 Danielsen, Sabrina I-9
 Dantis, Trudy G-4
 Daugherty, Dyron C-2
 Davidson, Hilary A-10, H-15
 Dawson, William F-16
 Day, Abby C-8, F-14
 Day, Katie C-7
 De Tavernier, Wouter E-15
 Demerath, N. Jay B-8, F-1
 den Dulk, Kevin H-9
 Denton, Melinda L. C-13
 Deroose, Kathryn Pitkin D-3
 Derr, Amelia I-2
 Devir, Nathan A-1
 Dillon, Michele C-5, D-7, H-6, J-6
 Doane, Michael J-11
 Dollahite, David C. C-13, D-4
 Doner, Jonathan J-3
 Dougherty, Kevin A-12, E-5, F-6, G-7
 Draper, Scott E-17, G-15
 Draulans, Veerle E-15
 Dromi, Shai J-15

E

Eagle, David A-3
 Ecklund, Elaine Howard E-9
 Edgell, Penny E-9, G-12, H-5
 Edman, Laird G-14, J-3

INDEX

Edwards, Korie A-12, B-1, J-6
 Eisenhandler, Susan A. E-2, F-14
 Eisenstein, Marie A-12
 Elliott, Marta J-11
 Ellis, Elexis E-12
 Ellis, Rachel F-12
 Ellis, Thomas F-3, H-2
 Ellis III, Rev. James E-7
 Ellison, Christopher G-7, J-5
 Engebretson, Kathleen D-15
 Esparza Ochoa, Juan Carlos B-10, D-10, J-10
 Evans, John H. B-9
 Evans, Michael A-12, D-14
 Everett, Laura G-5, H-3
 Everhart, Donald E-9

F

Fagen, Jennifer A-8
 Falasca-Zamponi, Simonetta B-8
 Farnsley II, Arthur E. D-3
 Fazito, Dimitri E-12
 Feierman, Jay E-6, F-3, G-1, H-2
 Feldman, Anat F-17
 Felke, Thomas F-11
 Fennell, Julie D-11
 Ferguson, Todd J-12
 Fidan, Ahmet G-12
 Finke, Roger F-8, H-5, Saturday Plenary
 Fisher-Townsend, Barbara C-1, D-12
 Fitchett, George A-2
 Fitz, Brittany I-6
 Flatt, Kevin D-5
 Flory, Richard C-9, H-6
 Foroutan, Yaghoob A-6, D-15, F-7, H-10
 Foster, Kirk E-11, I-12
 Francis, Leslie J. B-2, D-2, E-4, F-4, G-2
 Freston, Paul H-8
 Friesen, Amanda C-3
 Froese, Paul D-14, G-3
 Fuist, Todd B-12, G-16
 Fulton, Brad G-17

G

Gabel, Ines D-14
 Gallagher, Sally K. A-15, G-11
 Ganji, Rezvaneh B-15
 Garces-Foley, Kathleen B-1
 Garcia, Adriana G-4
 Garcia, Alfredo H-12
 Garfield, Andrew D-18
 Garlington, Sarah B-4
 Garma, Carlos D-10
 Gaunt, SJ, Tom J-2
 Gautier, Mary C-4, F-1, G-17, J-2
 Giordan, Giuseppe B-2, F-4
 Glanzer, Perry G-6
 Glazer, Jacob D-8
 Godazgar, Hossein I-5
 Goff, Philip D-3

Goldstein, Warren S. A-1
 Gonzalez, Alessandra G-3
 Goodman, Michael D-4
 Gooren, Henri C-10, D-10, F-11, G-9, H-7
 Gorsuch, Richard B-3
 Grant, Tobin H-9
 Gray, Mark C-4
 Green, Kyle E-9
 Gregorius, Fredrik J-14
 Grim, Brian A-6, B-10
 Gruis, Andrew D-4
 Guevara, Carmen D-17
 Guhin, Jeffrey B-9, G-3, J-8
 Gurrentz, Benjamin E-12, F-8
 Guth, James L. G-13
 Guthrie, Stewart F-3
 Guzman, Melissa F-17
 Gökarksel, Banu G-10

H

Hackett, Conrad A-6, C-8, F-2, G-11, H-5
 Hadjar, Ibnu I-11
 Haggard, Megan A-9, B-11
 Hahn, Jennifer D-12
 Hale, Amy A-4
 Hamar Martinez, Jessica D-3, G-17, J-4
 Hameed, Salman B-9
 Hart, Jonas F-15, H-10
 Hartberg, Yasha D-18
 Haskell, David D-5
 Hastings, Orestes 'Pat' G-12
 Hatun, Dogan I-9, J-8
 Hawthorne, John W. A-5
 Hayward, John I-13
 Hayward, R. David D-12, H-6
 Hegy, Pierre A-7, F-1, I-7, J-7
 Heiphetz, Larisa A-9
 Henderson, Matt B-15, I-6
 Hernandez, Edwin G-17, J-4
 Heywood, Bethany E-6
 Hill, Jonathan C-3, E-9, G-6
 Hirono, Tatsushi I-15
 Hirschle, Jochen I-12
 Hjelm, Titus I-10
 Hoang, Linh I-14
 Hoegeman, Catherine E-2, F-5
 Hoesly, Dusty A-8, E-15
 Hofer, Jeremy J-12
 Hoffmann, Mindy H-3
 Holtmann, Cathy C-1, D-6, F-12
 Homan, Casey C-13
 Hooge, Karen A-10, E-12
 Hoover, Brett G-17
 Hopkins, Peter G-10
 Hopp, Michael D-14
 Horowitz, Adam A-14
 Houseal, Rich D-4
 Howard Ecklund, Elaine G-7, H-4
 Hrotic, Steven J-3
 Hudiburg, Richard J-1
 Hughes, Philip I-10

Hull, Kathleen E-9

I

Iannaccone, Laurence C-5, F-8
 Iqbal, Asif A-13
 Irby, Courtney D-9, E-17
 Isaacs, Shelly A-10, D-16

J

Jacobs, Janet C-7, G-14
 Jankowski, Peter J. C-12
 Ji, Chang-Ho B-5
 Jindra, Ines C-10
 Johnson, Andrew E-14
 Johnson, Daniel G-14
 Johnson, David H-4
 Johnson, Mary E-2
 Johnson, Todd B-10
 Johnson Shen, Megan A-9
 Johnston, Erin E-3, G-15
 Jones, Dale F-17
 Josephsohn, Thomas J. G-16
 Jung, Jong Hyun G-12

K

Kadushin, Charles C-8
 Kaelber, Lutz H-4
 Kahle, Lynn D-18
 Kahn, Tara H-12
 Kang, Linda A-9
 Kapp, Deborah E-7
 Karpov, Vyacheslav C-11
 Karraker, Meg Wilkes G-4, I-8, D-2
 Kasun, Paul J-13
 Kawabata, Akira J-7
 Kayaoglu, Turan H-14
 Kearns, Laurel I-4
 Kelli, Smith C-6
 Kenda, Loren G-15
 Kersen, Thomas J-1
 Keysar, Ariela C-8, G-6, H-15
 Khan, Sabithulla J-15
 Killian, Mark G-8
 Kim, Chung-Hyun D-18
 Kim, Jichan I-2
 Kim, Sandy H-9
 Kim, Sung Gun C-9
 Klin-Oron, Adam C-10
 Klingenberg, Maria C-8
 Koch, Jerome I-11
 Koenig, Matthias H-10
 Koesel, Karrie H-8
 Konieczny, Mary Ellen A-15, E-12
 Kontala, Janne F-10
 Kopacz, Joelle A-3, I-1
 Kosmin, Barry G-6
 Krase, Jerome D-6
 Krause, Neal D-12, H-6
 Krindatch, Alexei E-7

INDEX

Kucinkas, Jaime E-9, I-15, J-13
Kuenkler, Mirjam I-16, C-15
Kurien, Prema F-12

L

Ladd, Kevin I-3
Laor, Yuval D-16
Larkin, Tom G-2
Lassander, Mika E-16, F-10, I-4
Lawson, Ronald A-1, I-8, J-9
Laycock, Patrick E-4
Le, Jennifer E-2
Lee, Ha Jung I-16
Lefebvre, Solange E-10
Leffel, G. Michael C-12
Li, Kati I-10, J-5
Li, Miao C-15, I-6
Lichtenstein, Matty C-13
Lindberg, Jonas G-13
Lindhardt, Martin E-14
Lindsay, Jennifer (Jenn) E-12
Ling, Richard J-7
Linhares, Fernando D-12
Lisovskaya, Elena C-11
Lizardy-Hajbi, Kristina E-8, J-12
Long, David B-9
Loveland, Matthew B-4, F-5
Lovheim, Mia C-8
Lu Qiu, Zoey B-14
Luft, Aliza F-5
Lummis, Adair T B-5, J-14
Lynch, Bobby E-3, F-11

M

Macaluso, Suzanne E-3, F-2
MacGregor, Carol Ann B-13, F-10
Maddox, Marion C-14, G-13, I-12
Magnusson, Magnus H-2
Manglos, Nicolette H-11
Mann, Marcus J-11
Manseur, Belkacem J-9
Marcum, Jack A-3, F-2
Markofski, Wes F-13
Marks, Loren D-4
Marsh, Christopher C-11
Marson, Jennifer F-13
Marti, Gerardo C-5, G-8, J-9
Martinez, Juan B-12
Mastrofini, Fabrizio F-4
Mathew, Mathews B-14, C-6
Mathias, Autumn A-13, F-15
Matoske, Jennifer A-4
Matthews, Luke G-1
Maurer, Danielle G-14
May, Jonathan F-7
Mayrl, Damon F-14
McAndrew, Siobhan E-16, G-11
McCallion, Michael A-7, C-4
McClure, Jennifer F-6, J-12
McConnel, Kirsten G-14, J-3

McCoy, Victoria I-10
McGill, Jenny A-14
McGuire, Meredith H-1
McGuire, Michael F-3
McKenzie, German A-8
McKinney, Jennifer F-6
McMullin, Steve C-1, E-13, G-11
Meintel, Deirdre J-1
Melton, J. Gordon F-9
Mencken, Carson I-6
Merino, Stephen E-11, F-10, I-2
Meyer, Katherine G-3, I-16
Mickulas, Peter D-7
Miller, Donald F-11
Miller, Robert B-6
Miller, Sharon L. C-3, E-7, I-1
Minton, Elizabeth D-18
Miranda-Ribeiro, Paula E-12
Mirola, William F-15, G-6
Moff Hudec, Amy I-15
Mohamed, Besheer E-5, H-11
Mohyuddin, Hasina I-10
Monnot, Christophe H-10
Montemaggi, Francesca I-6
Mooney, Margarita B-1, G-3, H-11, J-10
Moore, Colleen D-18
Mulder, Mark C-7, E-11
Munn, Chris D-9
Mustafa, Mentor A-11, J-8

N

Nason-Clark, Nancy C-1, D-6
Nawaz, Imran Haq E-3, J-1
Neeley, Sarah A-13, D-4
Nesbitt, Paula D. A-1
Nie, Fanhao H-15
Nielsen, Michael E-1, I-3, J-6
Ninh, Thien-Huong I-14
Nisanci, Zubeyir I-4
Norbeck, Alyssa F-7
Norris, Pippa Saturday Plenary
Norton, Jon, G-2
Novis Deutsch, Nurit J-3
Nynäs, Peter F-16, I-4

O

O'Brien, John H-10
O'Connell, Jake H-4
Offutt, Stephen A-7, J-10
Oldmixon, Elizabeth H-9
Olson, Daniel C-15, H-15, I-6
Olson, Elizabeth G-10
Olson, Laura C-6, F-1, G-13, I-15
Olson, Paul J. J-9
Oman, Doug C-5, E-6
Ong, Rosemarie I-13
Ospino, Hosffman G-17
Oubou, Hafsa E-13
Oviedo, Lluís B-10, C-4, H-2
Oyakawa, Michelle B-4

Özdil, Koray J-15
Ozorak, Elizabeth Weiss I-3

P

Packard, Josh A-4, G-8
Pain, Rachel G-10
Palmer, Susan A-8, F-9
Palmu, Harri G-12
Paloutzian, Raymond C-10
Pankhurst, Jerry G. D-9, A-11
Paris, Jenell E-13
Park, Jerry B-1, I-14
Park, John F-16
Park, Julie B-1, G-6
Payne, John E-4
Pena, Milagros J-4
Perkins, H. Wesley A-4
Perl, Paul C-15, J-2
Perry, Samuel I-4
Phillips, Bruce C-9
Phillips, Rick E-1
Pitt, Richard E-7, I-13
Plante, Thomas G. E-6
Plate, S. Brent H-13
Pogorelc, Anthony D-2
Porter, Nathaniel E-11, F-8, I-13, J-11
Possamai, Adam B-13
Possamai-Inesedy, Alpha F-16
Price, Heather B-4
Priest, Kersten A-10
Priest, Robert I-7, J-7
Probasco, LiErin J-10
Prout, Tracy H-12
Puetz, Michael G-16
Pugh, Brandie C-15
Purzycki, Benjamin H-2

R

Rabl, Marlen D-6
Radji, Mustapha J-9
Raghavan, Kalashreen B-15
Ramirez-Johnson, Johnny F-16
Reeh, Niels E-17
Reimer, Sam D-5, H-4
Rexhausen, Jeff B-6
Reynolds, Amy F-7
Reynolds, Robert B-15
Rhodes, Jeremy A-4
Richardson, James T. A-11, F-9
Richardson, Kelsy C-12
Rivera, Craig D-12
Robbins, Mandy E-4, G-2
Roberts, Alden I-11
Rogers, Anna E-17
Rogers, Megan B-14
Roland, Daniel R. I-7
Ronald, Emily A-14
Roof, Wade Clark G-13, Saturday Plenary
Roos, Micah B-9, H-11
Roose, Joshua B-13

INDEX

Roozen, David B-5
 Rosenthal, Michele D-13, E-13
 Rowatt, Wade A-9, B-11
 Rowe, Martin A-13, I-16
 Royle, Marjorie B-3, D-1, E-8, G-2
 Rozell, Mark H-9
 Ruiz, Andrea C-14
 Ruiz, Gionny H. E-10
 Rupert, Christopher D-2, H-12
 Ryan, Peter H-14
 Rymarz, Richard C-4

S

Sacchi, Franco H-13
 Sager, Rebecca I-9
 Salazar-Newton, Ariana J-4
 Salinas, Amanda D-15
 Samson, Matthew G-9
 Sandage, Steven J. C-12
 Santiago Dias Jr, Claudio D-8
 Sarkissian, Ani I-16
 Saunders, Carolyn J-2
 Schaefer, Andrew B-8, H-5, I-8
 Schall, Brunah D-8
 Scheitle, Chris H-4
 Schleifer, Cyrus E-11
 Schnettler, Bernt D-6
 Schnitker, Sarah A. C-12
 Schroeder, Rachel C-11
 Scott-Baumann, Alison I-5, J-3
 Secor, Anna G-10
 Servin Nieto, Maria Concepcion D-10
 Sezgin, Yüksel C-15
 Shah, Sarah C-14
 Shapiro, Ephraim D-8, J-5
 Sharp, Carissa B-11
 Sharp Penya, Lynette E-3, F-2
 Shaver, John G-1
 Sheikh, Christine Soriea I-6, J-5
 Sheikh, Farheen A-13
 Shepherd, Abigail M. C-12
 Shortell, Timothy D-6
 Sigalow, Emily A-14
 Sikkink, David A-12
 Skirbekk, Vegard A-6
 Smidt, Corwin G-7
 Smith, Buster F-10
 Smith, Daniel Jordan H-8
 Smith, Garrett D-18, I-12
 Smith, Jesse J-11
 Smith, Marty B-5
 Smith-Williams, Ida J. F-2, H-3
 Snell Herzog, Patricia B-4, C-3
 Song, Jae-ryon C-9
 Sorenson, Ritch I-8
 Sosis, Richard G-1
 Spelke, Elizabeth S. A-9
 Spickard, Jim C-2, G-16, H-1
 Starks, Brian A-15, G-17
 Stein, Tine I-16
 Stoddard, Brad I-11

Stolz, Jörg I-12, A-11
 Stonawski, Marcin A-6
 Storm, Ingrid A-11, D-17, G-11
 Stroope, Samuel A-3, F-14
 Suarez, Ana E-3, G-4
 Sullivan, Susan D-8
 Sun, Anna B-14
 Swatos, William H. F-14, I-11
 Swenson, Don E-17, F-17

T

Tamburello, Jeffrey A-5
 Tangenberg, Katy A-5
 Tanriverdi, Serhan J-8
 Taraba, Brittany E-3
 Taves, Ann C-5, G-10
 Teehan, John H-2
 Thomson, Bob F-2
 Thomson, Jr., J. Anderson I-6
 Thuesen, Peter D-3
 Thumma, Scott B-5, E-5
 Tom, Joshua D-13
 Tranby, Eric A-6, C-15
 Trinitapoli, Jenny B-13, F-16
 Trujillo, Matthew H-12
 Tsang, Jo-Ann I-3
 Tse, Justin K.H. G-10
 Tuch, Steven A. F-1
 Turam, Berna J-8
 Turkmen, Gulay J-8
 Turner, Bryan B-13, F-16

U

Uecker, Jeremy F-14
 Ulrich, Laurel Thatcher H-7

V

Vaidyanathan, Brandon C-3, I-8
 Valerio, Adam E-6
 van der Does, Tamara J-13
 Van Ness, Justin A-8, I-4
 Van Ryn, Maria C-15, H-14, J-9
 Velayati, Masoumeh I-5
 Velez, Robert H-9
 Vermurlen, Brad J-9
 Verona, Ana Paula D-8, E-12
 Village, Andrew E-4, F-4
 Villamayor-Tomas, Sergio D-18
 Vincett, Giselle G-10
 Viscelli, Stephen F-12
 Voas, David E-16, G-11
 Voorhees, Amy D-8

W

Wagner, Michael C-3
 Wariboko, Nimi C-2, H-13
 Warner, R. Stephen A-2, D-9, H-1, I-14
 Watanabe, Mitsuharu J-7

Watson, James I-1
 Weatherby, Georgie F-7
 Wedam, Elfriede B-5
 Weed, Bethany I-2
 Weinreb, Alexander B-13
 Wellman, James K. J-14
 Whitehead, Andrew A-3, C-13, F-6
 Whitnah, Meredith J-15
 Wicks, Don A. I-7
 Wilde, Melissa F-12
 Wildman, Wesley G-1
 Wildman-Hanlon, Laura D-11
 Wilkes Karraker, Meg D-2
 Williams, Malcolm V. D-3
 Williams, Rhys A-15, B-12, D-9, G-16, H-6
 Williams, Roman R. B-15, C-7, D-6
 Williamson, David J-11
 Wilson, Burgess F-3
 Winchester, Daniel E-9
 Wink, Paul C-5
 Wittberg, Patricia B-6, E-8
 Wollschleger, Jason F-15, G-8
 Wolny, Witold H-4
 Wood, Andrew E-15
 Wood, Connor G-1
 Wood, Richard G-17, H-8
 Woodberry, Robert D-10, J-10
 Woodrick, Anne D-4
 Woolever, Cynthia A-3, H-5
 Wright, Brad J-1
 Wright, Stuart A-8
 Wulff, David E-16
 Wurgler, Emily D-14

X

Xu, Xiaohu J-5

Y

Yancey, George H-4, J-11
 Yang, Fenggang C-15
 Yelderman, Logan A-9
 Yilmaz, Murat G-12, I-9, J-8
 Yoder, Kendra C-1
 Yoo, Kwang Suk C-9
 York, Michael D-11
 Yukich, Grace B-12

Z

Zayac, Ryan I-10
 Zech, Charles B-6
 Zubrzycki, Genevieve Saturday Plenary
 Zulkowski, Samantha A-6, C-15



Online Resources

Contact us for pricing options or free 30-day institutional trials:
sales-nl@brill.com
 (outside the Americas)
 or sales-us@brill.com
 (inside the Americas).

Highlights of Religious Studies and Theology at Brill

Visit Brill's booth at the book exhibit for a 50% discount off display copies!

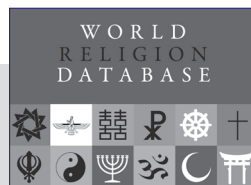

brill.com/wrd

• ISSN 1876-1410

Purchase options

- Annual subscription
- Outright purchase

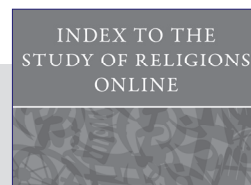

brill.com/isro

- ISSN 1876-6641
- Also available in print

Purchase options

- Annual subscription
- Outright purchase

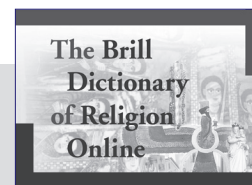

brill.com/bdro

- ISSN 1872-5287
- Also available in print

Purchase options

- Annual subscription
- Outright purchase

Journals

Free sample copies
 available at our booth



brill.com/arp

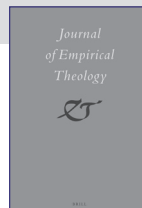

brill.com/jet



brill.com/jra

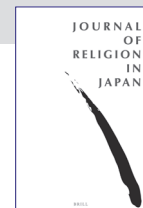

brill.com/jrj



brill.com/wo

Interested in a sabbatical opportunity or post-doctoral fellowship?

The Collegeville Institute invites applications for the 2014/2015 Resident Scholars Program.

The program brings together well-trained, creative, articulate men and women for careful thought in a place of inquiry and prayer. Applicants are encouraged to apply for either a semester or a full academic year. Additionally, applicants whose research addresses the intersection of faith and culture in contemporary society are eligible to apply for one of the following:

- **Collegeville Institute Post-doctoral Fellowship**
(designed for scholars who have recently earned doctoral degrees)
- **Kilian McDonnell Fellowship in Faith and Culture**
(designed for accomplished scholars on sabbatical leave)

Scholars awarded a residency enjoy housing on our lakefront campus, integration into a unique learning community, and the time and space necessary for productive research.

Oriented to Christian faith, the Institute also welcomes scholars from other religious traditions. The Institute accepts applications from abroad as well as the United States. People of color are encouraged to apply.

Application deadline:

January 15, 2014

For details visit:

CollegevilleInstitute.org

The Collegeville Institute is located on the campus of St. John's University and Abbey, a Benedictine institution in Collegeville, Minnesota.

**COLLEGEVILLE
INSTITUTE** 
FOR ECUMENICAL & CULTURAL RESEARCH

Visit our display for
a special discount!

NYUPRESS

Keep reading.

The Divided Mind of the Black Church

Theology, Piety, and Public Witness
RAPHAEL G. WARNOCK

\$30.00 • CLOTH

In the *Religion, Race, and Ethnicity* series

Religion Out Loud

Religious Sound, Public Space,
and American Pluralism
ISAAC WEINER

\$25.00 • PAPER

In the *North American Religions* series

The Spectacular Few

Prisoner Radicalization and
the Evolving Terrorist Threat
MARK S. HAMM

\$24.00 • PAPER

God's Gangs

Barrio Ministry, Masculinity,
and Gang Recovery
EDWARD OROZCO FLORES

\$24.00 • PAPER

Fire in the Canyon

Religion, Migration, and
the Mexican Dream
LEAH M. SARAT

\$24.00 • PAPER

The Color of Sound

Race, Religion, and Music in Brazil
JOHN BURDICK

\$25.00 • PAPER

The New American Zionism

THEODORE SASSON

\$39.00 • CLOTH

Crossing the Water and Keeping the Faith

Haitian Religion in Miami
TERRY REY AND ALEX STEPICK
FOREWORD BY
ARCHBISHOP THOMAS WENSKI

\$24.00 • PAPER

In the *North American Religions* series

Pagan Family Values

Childhood and the Religious Imagination
in Contemporary American Paganism
S. ZOHREH KERMANI

\$25.00 • PAPER

In the *New and Alternative Religions* series

Gülen

The Ambiguous Politics of
Market Islam in Turkey and the World
JOSHUA D. HENDRICK

\$49.00 • CLOTH

Islam is a Foreign Country

American Muslims and
the Global Crisis of Authority
ZAREENA GREWAL

\$25.00 • PAPER

In the *Nation of Newcomers* series

Living Out Islam

Voices of Gay, Lesbian,
and Transgender Muslims
SCOTT SIRAJ AL-HAQ KUGLE

\$25.00 • PAPER

An Unusual Relationship

Evangelical Christians and Jews
YAAKOV ARIEL

\$39.00 • CLOTH

WINNER OF THE 2012 C. CALVIN SMITH AWARD

Blacks and Whites in Christian America

How Racial Discrimination
Shapes Religious Convictions
JASON E. SHELTON AND
MICHAEL O. EMERSON

\$28.00 • PAPER

In the *Religion and Social Transformation* series

Divine Callings

Understanding the Call to
Ministry in Black Pentecostalism
RICHARD N. PITT

\$25.00 • PAPER

The Post-Secular in Question

Religion in Contemporary Society
EDITED BY PHILIP GORSKI,
DAVID KYUMAN KIM, JOHN TORPEY
AND JONATHAN VANANTWERPEN

\$55.00 • CLOTH

Co-published with the
Social Science Research Council

Sacred Subdivisions

The Postsuburban Transformation
of American Evangelicalism
JUSTIN WILFORD

\$24.00 • PAPER

Sustaining Faith Traditions

Race, Ethnicity, and Religion
among the Latino and Asian American
Second Generation
EDITED BY CAROLYN CHEN
AND RUSSELL JEUNG

\$28.00 • PAPER

All books also available as e-books.

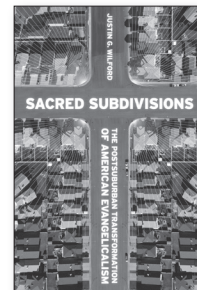
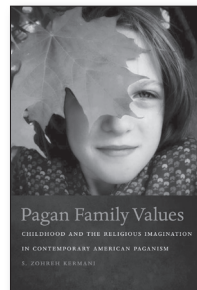
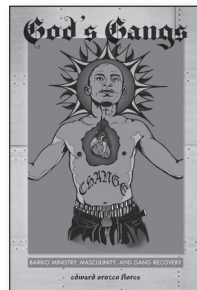
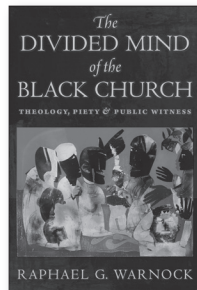

www.nyupress.org

NEW SERIES!

RELIGION AND ITS OTHERS: STUDIES IN RELIGION, NONRELIGION AND SECULARITY

SERIES EDITORS

Dr. Stacey Gutkowski, Kings College London

Dr. Lois Lee, University College London

Dr. Johannes Quack, Goethe-Universität, Frankfurt

The new series *Religion and Its Others: Studies in Religion, Nonreligion and Secularity (RIO)* is the first to consider the multiple relations between religion, nonreligion, and secularity. Monographs, edited volumes, and readers in this series are concerned with the forming and reforming of religious traditions in relation to their cultural and political contexts, their boundaries, and what is beyond those boundaries. The series explores apparently nonreligious or 'irreligious' phenomena that are significantly related to religion (including forms of atheism, agnosticism, indifference) and modes of differentiation between religion and its various others, often institutionalized in cultural, legal, and political orders. Affiliated with the interdisciplinary Nonreligion and Secularity Research Network (<http://nsrn.net>), the series invites proposals from across disciplines, including religious studies; anthropology, sociology, and psychology of religions; history and philosophy of religions; political, cultural, and area studies; media and communication studies; and studies of visual and performing arts.

Research areas of interest include:

- ▶ the various modes of differentiation between religion and its others;
- ▶ the various kinds of nonreligion and nonreligious-religious interrelations – the critical, pejorative, and radically secularist as well as the curious, admiring, or covetous and the distant, ignorant, or indifferent;
- ▶ civic, juridical, and political as well as aesthetic, material, emotional, practical, or spatial manifestations of these relations.

We welcome proposals and ideas for the new series. Please contact Dr. Alissa Jones Nelson, Acquisitions Editor for Religious Studies, in the first instance: Alissa.JonesNelson@degruyter.com



DE GRUYTER

www.degruyter.com

RELIGIOUS RESEARCH ASSOCIATION

CALL FOR PAPERS

**2014 Annual Meeting
October 31-November 2, 2013
JW Marriott, Indianapolis, Indiana**

Revisiting Gender and Religion

Gender is a fundamental element of religious life. Understanding the relationship of gender to religion has been of sustained interest to scholars and practitioners alike, though the level of attention has varied. During the 1970s, scholarship on religion and gender began to expand dramatically, transforming questions, challenges, and directions for future research. Changes in our global world in the intervening years—in the social dynamics of gender, in the nature of religious leadership, participation, practice, politics, and social action—are due for renewed and continued scholarly attention, lending urgency to this opportunity to revisit gender and religion.

Presentations are welcome at this meeting on all topics related to the social dimensions of religion, particularly organized religion as that reflects the traditional focus of the RRA. Topics related to gender and religion might include, among others:

- theories and concepts of gender in relation to theories of religion
- gender and religion in international and/or comparative contexts
- implications of gender embedded in the rise of nationalisms
- intersections of gender, religion, and politics
- changes in the presence of women and men in leadership of religious organizations
- dynamics of gender within religious organizations
- gendering of religious communities, such as “Cowboy Churches”
- women as majority participants in religious organizations and movements
- faiths and feminisms
- religious socialization and gender identities
- intersections of gender, sexuality, and sexual orientation
- religious organizations and LGBTQ issues and identities
- gender in faith-based service, relief efforts, development
- religion and harm: durable inequalities, violence, sexual misconduct, and other “dark sides” of religion and gender

Submit all session and paper proposals through the online portal found at the following link, choosing the RRA option on the submission form: www.sssrweb.org.

Submissions of sessions and individual paper proposals opens: February 3, 2014

Submissions close: March 31, 2014

Direct questions to RRA Program Chair LiErin Probasco, probasco@alumni.princeton.edu

Society for the Scientific Study of Religion

CALL FOR PAPERS

**2014 Annual Meeting
October 31-November 2, 2014
JW Marriott, Indianapolis, Indiana**

Building Bridges

SSSR's current web site notes:

The Society for the Scientific Study of Religion was founded in 1949 by scholars in religion and social science. Its purpose is to stimulate and communicate significant scientific research on religious institutions and religious experience. Scholars from all fields of study who are interested in the scientific exploration of religion are invited to join the Society. Membership in the Society for the Scientific Study of Religion gives scholars the opportunity to share their research and ideas with other scholars.

Our theme for the 2014 conference is "Building Bridges" between all those interested in the study of religion. This includes any disciplines that focus upon the study of religion as well as scholars from the widest possible geographical and cultural areas. Our intent is to build bridges between disciplines and cultures that have become isolated and communicate only among themselves and not to others with similar interests but from different perspectives. Suggestions for contributions include:

- the study of religion in diverse cultures and regions (Eastern, Central Europe, Asia, South America, etc.)
- the study of religion within diverse faith traditions (Islam, Christianity, Paganism, NRMs, etc.)
- inter-disciplinary studies of religion (religious studies & the social and behavioral sciences, etc.)
- new disciplines that study religion (cognitive science, evolutionary psychology, etc.)
- methodology interaction in the study of religion (quantitative, qualitative, creative, etc.)
- the study of non-belief and atheism

All session and paper proposals must be submitted via the on-line submission system that will be available on the SSSR's web site, <http://www.sssrweb.org>. In addition to the session proposer's full contact information, a session proposal requires a session title and an abstract of not more than 150 words describing the goal of the session and how the proposer expects the session to contribute to scientific knowledge about religion. Individual paper proposals require the name(s) of the author(s), first author's full contact information, an abstract of not more than 150 words that succinctly describes the question(s) motivating the research, the data and methods used, and what the paper contributes or expects to contribute to the knowledge or understanding of religion.

Submissions Open: February 03, 2014 (see <http://www.sssrweb.org>)

Submissions Close: March 31, 2014

Decision Notification: April 30, 2014

Please direct questions to: Ralph Hood (UTC), Program Chair (Ralph-Hood@utc.edu)
Co-chair for Asia-Pacific region: Alpha Possamai-Inesedy (Alpha.Possamai@uws.edu.au)
Co-Chair for Western, Central, and Eastern Europe: Elisabeth Arweck (Elisabeth.arweck@warwick.ac.uk)
Special assistant for developing sessions on Islam: Besheer Mohamed (BMohamed@PewResearch.org)
Graduate Student Representative: Christopher F. Silver (Christopher-Silver@utc.edu)

Thank you to...

...Oxford University Press for once again sponsoring the New Book Reception.

...Brill, DeGruyter, and Lexington Books for sponsoring author's tables at the New Book Reception.

...Tricia Bruce for serving as SSSR Program Chair. Tricia took in all meeting proposals, created the SSSR sessions, and then worked with the RRA program chair to merge all sessions into a seamless program.

...Perry Chang for serving as RRA Program Chair. Perry did the same job with the RRA sessions and then worked with Tricia to create the final product.

...Becky Vasko from the Center for the Study of Religion and American Culture at IUPUI, who once again formatted the program you are holding and arranged for it to be printed. She also helps Joy at the meeting registration desk.

...Joy Sherrill who, although now retired from IUPUI, continued to do the administrative work of SSSR, processing all memberships and meeting registrations. Joy is also running the registration desk at the meeting for the 7th consecutive time.

...Art Farnsley for his 7th year of service as SSSR Executive Officer. Art coordinated all hotel arrangements, member communications, and countless miscellaneous tasks essential to a successful meeting.

CONCOURSE LEVEL

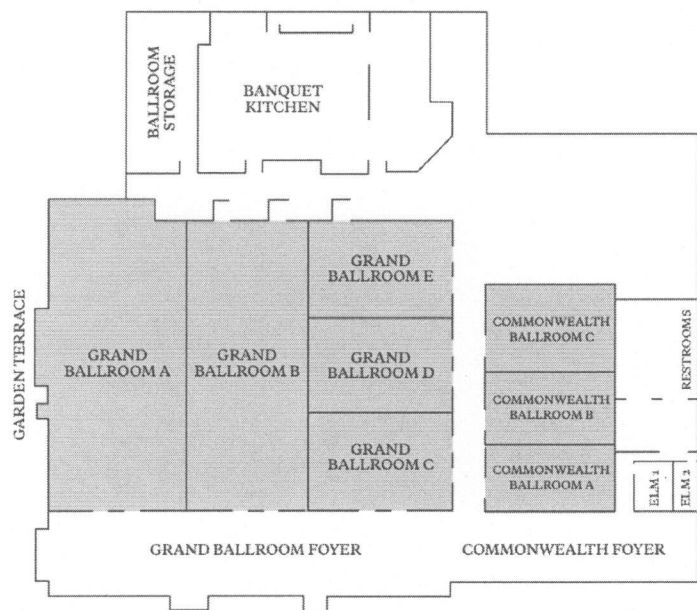

MEZZANINE LEVEL

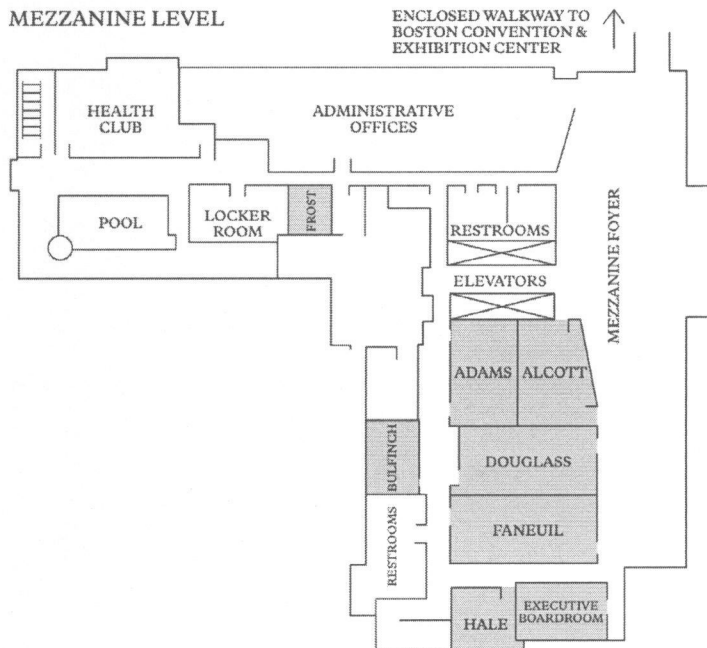

LOBBY LEVEL



THE WESTIN BOSTON WATERFRONT

CONFERENCE LEVEL

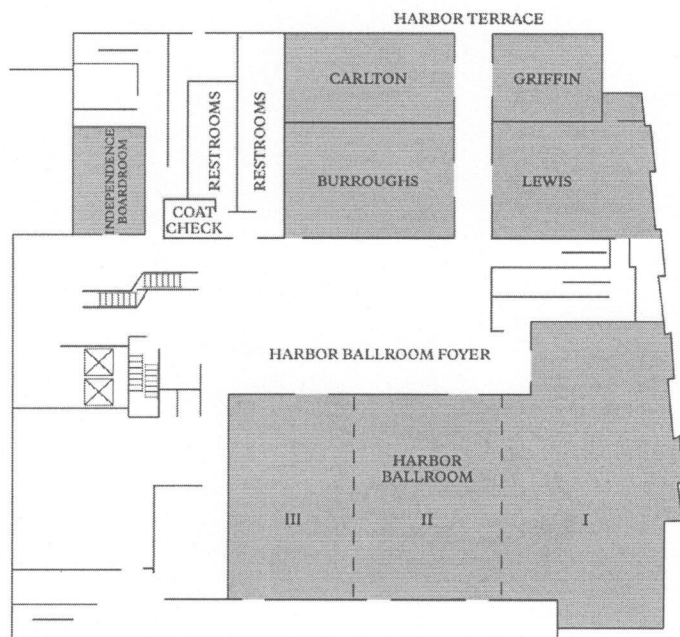

GALLERIA LEVEL

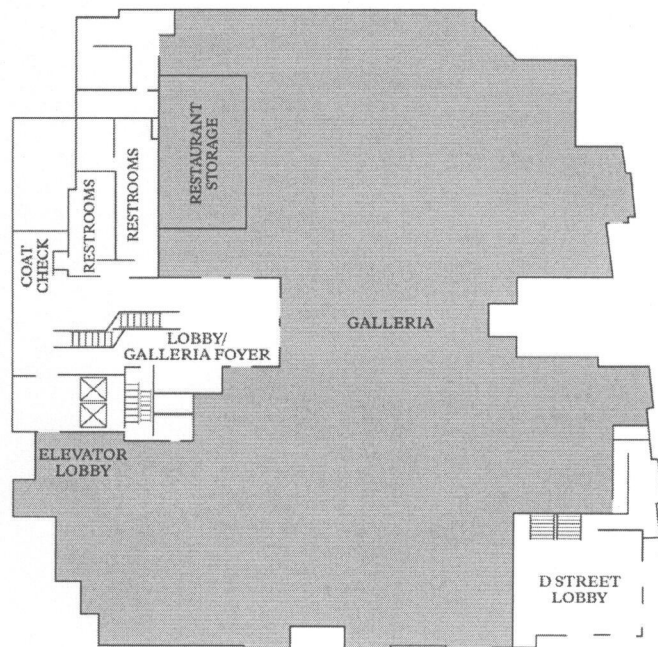

Presidents of SSSR

1949 Walter H. Clark (CSSR)
1952 Talcott Parsons (CSSR)
1954 Prentiss Pemberton (CSSR)
1956 CSSR becomes SSSR
1956 Richard V. McCann
1958 James Luther Adams
1960 Horace Kallen
1962 Horace L. Friess
1964 Walter H. Clark
1966 Peter L. Berger
1968 Charles Y. Glock
1970 Joseph H. Fichter
1974 Paul W. Pruyser
1976 Allan W. Eister
1978 William V. D'Antonio
1980 Benton Johnson
1982 Marie Augusta Neal
1984 Jeffrey K. Hadden
1986 Phillip E. Hammond
1988 Meredith McGuire
1990 Donald Capps
1992 Eileen Barker
1994 Ruth Wallace
1996 Wade Clark Roof
1998 Jay Demerath
2000 Helen Rose Ebaugh
2002 Robert Wuthnow
2003 Rodney Stark
2004 Nancy Ammerman
2005 Donald Miller
2006 R. Stephen Warner
2007 Dean Hoge
2008 Mark Chaves
2009 Katherine Meyer
2010 James Beckford
2011 Rhys H. Williams
2012 Michele Dillon

Presidents of RRA

1959 Lauris B. Whitman
1962 Walter Kloetzli
1965 Paul Mundy
1967 George W. Kaslow, Jr.
1971 Thomas G. Gannon
1972 James E. Dittes
1974 Earl D. Brewer
1976 Ross P. Scherer
1978 Barbara J.W. Hargrove
1980 Dean Hoge
1981 G. Douglass Lewis
1982 David O. Moberg
1983 Jackson W. Carroll
1984 William McKinney
1985 Constant H. Jacquet
1987 Hart M. Nelson
1989 James D. Davidson, Jr.
1991 Wade Clark Roof
1993 Peggy L. Shriver
1995 Benton Johnson
1997 Carl S. Dudley
1999 Edward C. Lehman, Jr.
2000 D. Paul Johnson
2002 Nancy Nason-Clark
2004 Daniel V.A. Olson
2006 Kirk Hadaway
2008 Keith Wulff
2010 John Bartkowski
2012 Joy Charlton